

EYDX 40% Fill Expanded Fill Sealing Fittings for Close Turning Radius

Explosionproof, Dust-Ignitionproof, Raintight

For Use with Threaded Rigid Metal Conduit and IMC.

NEC/CEC:

Class I, Division 1 and 2, Groups A◇, B◆, C, D
 Class II, Division 1 and 2, Groups E, F, G
 Class III

Trade Size (Inches)	Millimeters (Inches)			Kwiko™ A Cement Required Grams (Ounces)	Catalog Number Ductile/Malleable Iron
	A (Length)	B (Width)	Turning Radius ①		

EYDX Female 1/2"-4" Vertical Drain Seals for Close Turning Radius

	1/2	3-11/16	1-1/4	1-1/2	114 (4.00)	EYDX-50
	3/4	4-5/16	1-3/8	1-3/4	170 (6.00)	EYDX-75
	1	5-1/16	1-3/4	2-3/16	198 (7.00)	EYDX-100
	1-1/4	5-1/2	2-1/16	2-7/16	369 (13.00)	EYDX-125
	1-1/2	6-1/4	2-5/16	3	624 (22.00)	EYDX-150
	2	7-1/2	2-5/8	3-1/2	1021 (36.00)	EYDX-200
	2-1/2	8-1/2	3	4-1/4	1729 (61.00)	EYDX-250
	3	9-3/16	3-5/16	4-3/4	2523 (89.00)	EYDX-300
	4"					

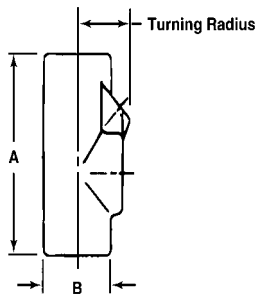

* Per NEC 501.15(C)(6), seals in Class I, Division 1 and 2 must be limited to conductor fill of 25% of cross sectional area of a rigid metal conduit of the same trade size unless approved for higher percentage fill. See 40% fill sealing fittings.

① Turning radius with cover or plug removed.

EY 25% * Fill Vertical Sealing Fittings for Close Turning Radius

Explosionproof, Dust-Ignitionproof, Raintight

For Use with Threaded Rigid Metal Conduit and IMC.

NEC/CEC:

Class I, Division 1 and 2, Groups A◇, B, C, D
 Class II, Division 1 and 2, Groups E, F, G
 Class III

Trade Size (Inches)	Millimeters (Inches)			Kwiko™ A Cement Required Grams (Ounces)	Catalog Number Grayloy™ Iron
	A (Length)	B (Width)	Turning Radius ①		
EY Vertical Sealing Fittings (25% fill)					
Female					
1/2	3-1/4	1-3/16	1-1/8	2	EY-50
3/4	3-5/8	1-1/4	2-3/8	3	EY-75
1	4-1/4	1-3/8	2-3/4	5	EY-100
1-1/4	5-1/16	2-15/16	2	11	EY-125
1-1/2	5-1/2	2-1/2	3-1/2	19	EY-150
2	6-1/4	2-1/8	3-15/16	31	EY-200
Male/Female (Removable Male Nipple)					
1/2	4-15/16	1-3/16	1-1/8	2	EYM-50
3/4	5-19/64	2-1/4	1-3/8	3	EYM-75
1	6-1/32	2-3/8	1-3/4	5	EYM-100
1-1/4	5-13/16	2	2-5/8	6	EYM-125
1-1/2	6-1/4	2-1/4	3	9	EYM-150
2	7	2-3/4	3-5/8	15	EYM-200

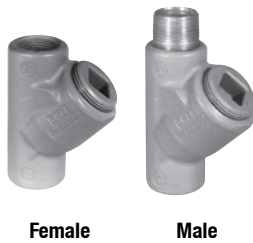

Female

Male



Type EY

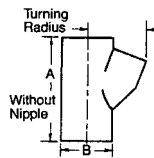

Type EYM

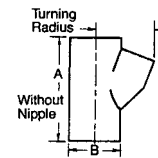

* Per NEC 501.15(C)(6), seals in Class I, Division 1 and 2 must be limited to conductor fill of 25% of cross sectional area of a rigid metal conduit of the same trade size unless approved for higher percentage fill. See 40% fill sealing fittings.

① Turning radius with cover or plug removed.

◇ Indicates items in the shaded area which are UL Listed for Class I, Groups A, B, C, D; Class II, Groups E, F, G; and Class III.