

Mechanical Dimensions: Inches [mm]

Drawing A

Tolerances ± 0.012 [0.3] Unless Otherwise Specified

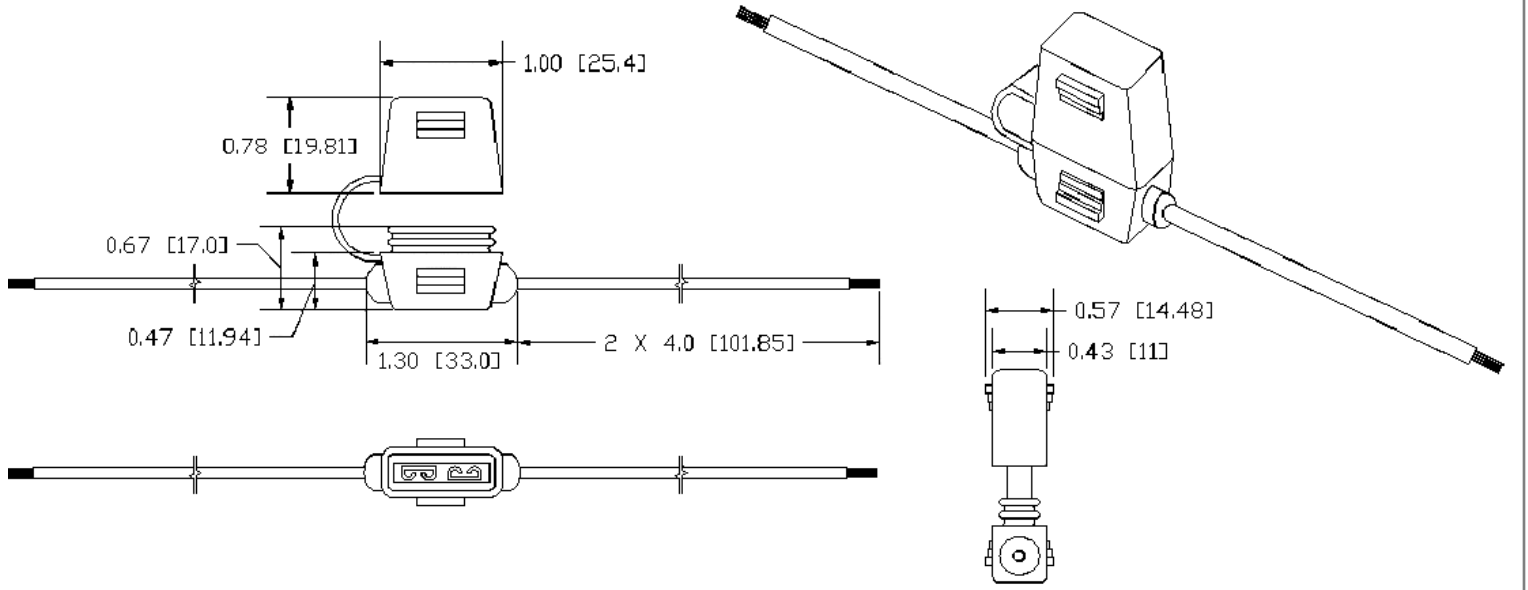

Drawing B

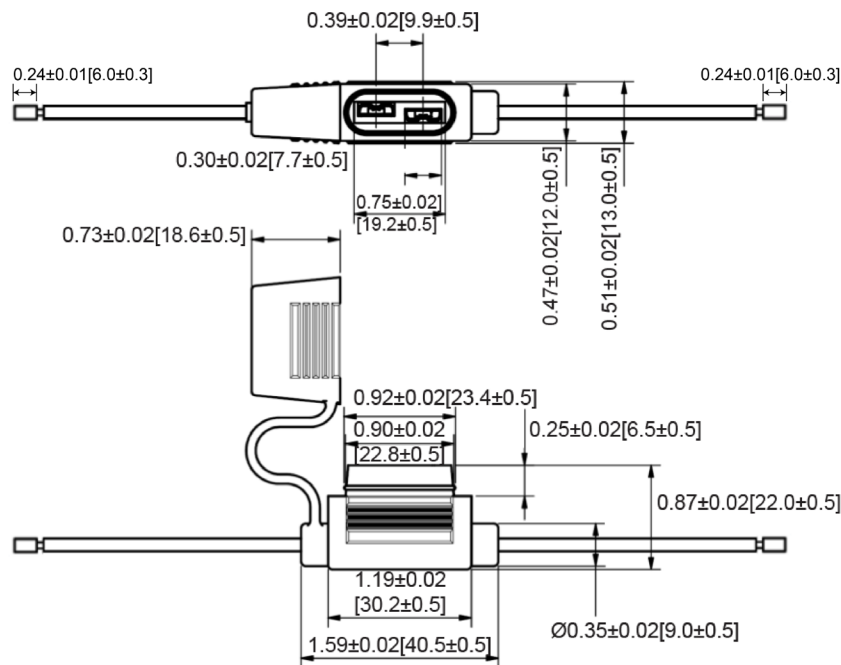

Part Numbers Information

LPR - 02	B	12	R	BP
BODY COLOR	WIRE GAUGE	WIRE COLOR	PACKAGING	
B: Black	12: 12AWG 14: 14AWG 16: 16AWG 18: 18AWG*	R: Red B: Black OR: Orange Y: Yellow	Blank: Bulk BP: Blister Pack (1pc)	

Wire Gauge	Max Amp.
12 AWG	30A
14 AWG	20A
16 AWG	15A
18 AWG	10A

In-Line Regular (ATO/ATC Style) Blade Fuse Holder

LPR-02



Electrical Specifications

Voltage Rating 125VDC; 250VAC

Temperature Rating -40°C ~85°C

Material Specifications

For use with APR and ANR Regular (ATO/ATC Style) Blade Fuses

Body Material PVC (UL94V-0)**

Contact Material Brass

Wire Length 4" Each End

Wire Type UL 1015 rated to FT1 (VW1) - Stranded

Ingress Protection IP67

For custom inquiries please contact the factory

**Rating for 12AWG~16AWG models only. Tested internally.

Reference Drawing Table

Part #	Drawing
LPR-02B-12B	Drawing A
LPR-02B-12OR	Drawing A
LPR-02B-12OR-BP	Drawing A
LPR-02B-12R	Drawing B
LPR-02B-12Y	Drawing A
LPR-02B-12Y-BP	Drawing A
LPR-02B-14B	Drawing B
LPR-02B-14R	Drawing A
LPR-02B-14R-BP	Drawing A
LPR-02B-14Y	Drawing A
LPR-02B-16B	Drawing A
LPR-02B-16B-BP	Drawing A
LPR-02B-16R	Drawing A
LPR-02B-16Y	Drawing A
LPR-02B-16Y-BP	Drawing A
LPR-02R-16R	Drawing A
LPR-02B-18R	Drawing B
LPR-02B-18R-LOOP	Drawing A
LPR-02B-18Y	Drawing A

Retail Pack: Inches [mm]

Retail Pack #

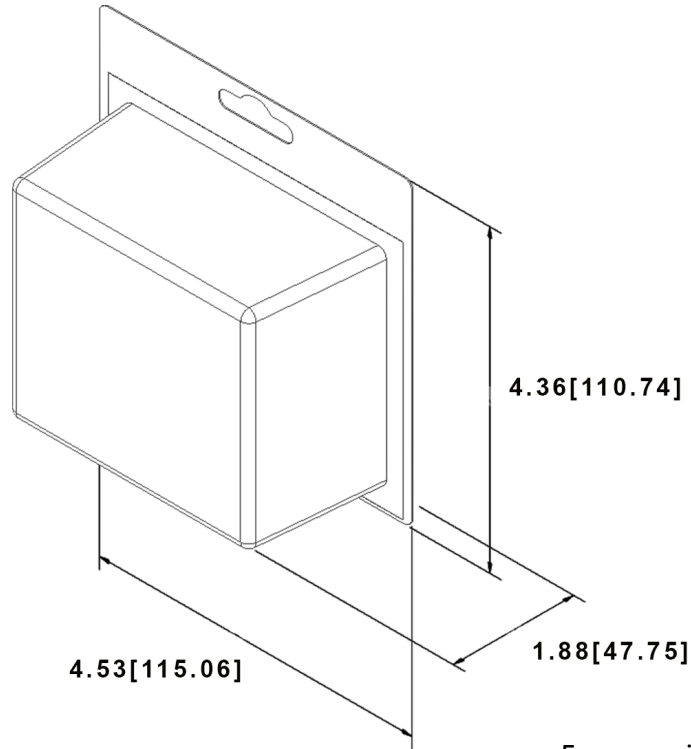

For use with 12AWG-14AWG wire size

Retail Pack: Inches [mm]

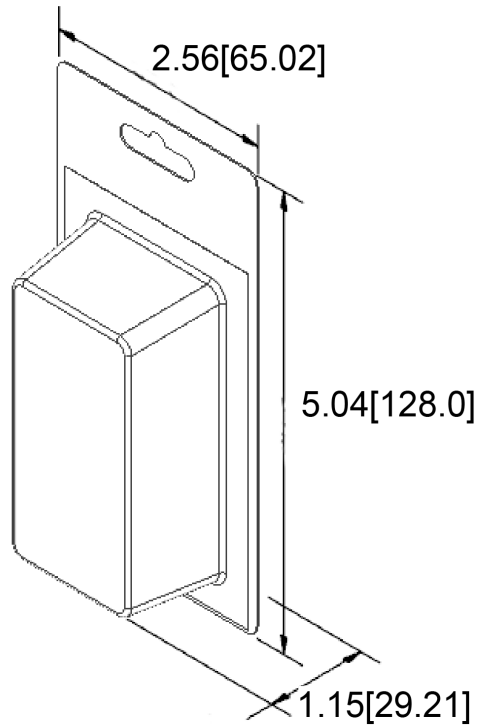

For use with 16AWG-18AWG wire size

The specifications on this page has been reviewed and approved by:

X _____

Disclaimer: Information provided is believed to be accurate and reliable. Users are responsible for confirming the suitability and performance of any OptiFuse product for their particular application. These products may not be appropriate for every use, and proper evaluation is recommended before implementation. For additional information, please visit [optifuse.com/product-disclaimer](https://www.optifuse.com/product-disclaimer).

Specifications are subject to change without notice

Rev	Date of issue	Revision Notes	Designed	Approved
G	03-31-2026	Updated Drawing, add half strips dimension	RC	OF