

Special Purpose Circuit Breakers

60°C / 75°F Conductor Rating

Box Type Terminals

Quick-Make, Quick-Break

Multi-pole Breakers Incorporate Internal Common Trip

PowerMark Gold Main Circuit Breaker Kit

For use with 125A PowerMark Gold load Centers; 22kAIC RMS symmetrical.

Description	Product Number
Main Circuit Breaker Kit - Order appropriate THQL 10kAIC or THHQL 22kAIC breakers separately. Includes service barriers for use with THQL or THHQL main.	TQM000 ¹

¹ Please review the footnotes listed with the individual Load Center product numbers for proper parts needed to convert to a main circuit breaker. This main breaker base is only applicable for 16 circuit and larger 125 amp load centers, 12 circuit load centers with A C24 suffix, and the TLM812RCU2.

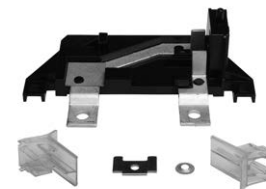

TQM000

Ground Fault with Equipment Protection

cULus

Ground Fault Circuit Interrupters No. 943 30 milliampere ground fault trip level

	Ampere Rating	1-Pole, 120 Volts ac Product Number	2-Pole, 120/240 Volts ac Product Number
10,000 AIC	15	THQL1115GFEP	THQL2115GFEP
	20	THQL1120GFEP	THQL2120GFEP
	30	THQL1130GFEP	THQL2130GFEP
22,000 AIC	15	-	THHQL2115GFEP
	20	-	THHQL2120GFEP
Std. Pkg.		10 Cartons of 1	10 Cartons of 1



THQL2115GFEP

Switching Neutral

UL Listed. 10kAIC RMS symmetrical.

Standard 1- or 2-pole automatic breaker plus one fully-rated, non-automatic pole.

	Ampere Rating	1-Pole Plus Switching Neutral 120/240 Volts ac Product Number	2-Pole Plus Switching Neutral 120/240 Volts ac Product Number
10,000 AIC	15	THQL21WY15	THQL31WY15
	20	THQL21WY20	THQL31WY20
	25	THQL21WY25	THQL31WY25
	30	THQL21WY30	THQL31WY30
Std. Pkg.		5 cartons of 5	5 cartons of 3



THQL21WY30

"HID" Lighting

UL Listed as HID. HID breakers have been designed to handle the current and voltage spikes that result when gaseous discharge lamps, including fluorescent and HID lamps, are switched on and off.

	Ampere Rating	1-Pole, 120/240 Volts ac Product Number	2-Pole, 120/240 Volts ac Product Number
10,000 AIC	15	THQL1115HID ²	THQL2115HID
	20	THQL1120HID ²	THQL2120HID
	30	THQL1130HID	THQL2130HID
22,000 AIC	15	THHQL1115HID ²	THHQL2115HID
	20	THHQL1120HID ²	THHQL2120HID
	30	THHQL1130HID	THHQL2130HID
Std. Pkg.		5 cartons of 10	5 cartons of 5



THQL2120HID

² UL Listed as SWD (switching duty). Suitable for 120 volts ac fluorescent lighting loads.

High Magnetic

UL Listed. 10kAIC RMS symmetrical

High short circuit setting suitable for circuits with inherent high-inrush load currents.

	Ampere Rating	1 Pole, 120 Volts ac Product Number
	15	THQL1115HM
	20	THQL1120HM
	25	THQL1125HM
	30	THQL1130HM
	40	THQL1140HM
	50	THQL1150HM
Std. Pkg.		5 cartons of 10



THQL1140HM