

# Class 2 UL 5085-3 or ETL Recognized Transformer

Series: CL

Power Rating: **50VA**

- Class 2 Recognized UL File E49606 or ETL File 100920584CHI-001
- UL 1446 Recognized Class F 155°C Insulation System File E95662
- 50/60Hz Operation
- No Fuse Required
- Input: Hook-up Wires #18 AWG UL Style 3173, 600V, 125°C
- Output: Hook-Up Wires #18 AWG UL Style 3173, 600V, 125°C
- All leads are 12.0" L.O.C (length out of coil) 1/2" strip
- No. of Lead Wires and Color Code as per Schematic.



FRONT VIEW

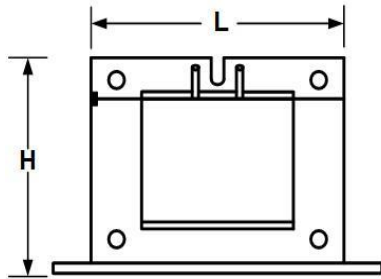

SIDE VIEW

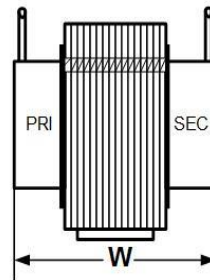

TOP VIEW

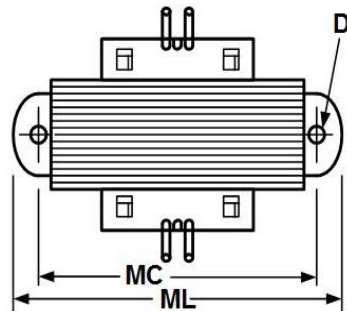

| DIMENSIONS |        |
|------------|--------|
| L          | 2.625" |
| H          | 2.210" |
| W          | 2.470" |
| MC         | 3.125" |
| ML         | 3.565" |
| MH         | -      |
| D          | 0.188" |
| B          | -      |
| C          | -      |
| F          | -      |

| UNIT WEIGHT     |  |
|-----------------|--|
| Approx 0.968Lbs |  |

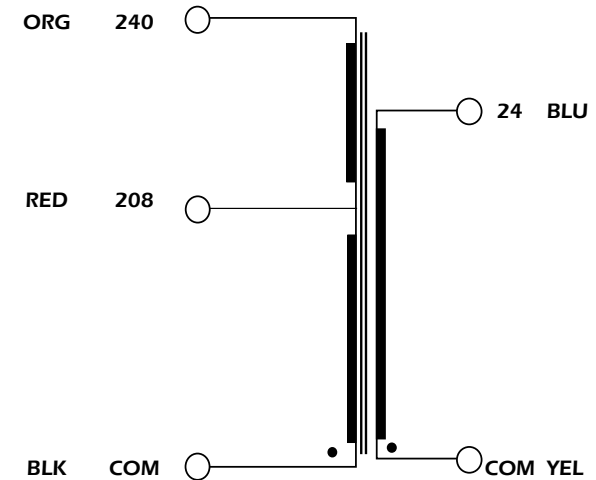

CUSTOMER P/N:



300 W Factory Road  
Addison, IL 60101 USA  
TEL: 630-628-9999  
FAX: 630-628-9922  
www.wabashtransformer.com

DESCRIPTION:

Transformer, UL Class 2 Recognized  
208/240V 50/60Hz 24V 50VA

MODEL:

**CL50AW15-X-HXN**

|     |            |
|-----|------------|
| 0   | 1-Apr-2019 |
| REV | DATE       |