

Item No.: WE8B-DK

Installation guide

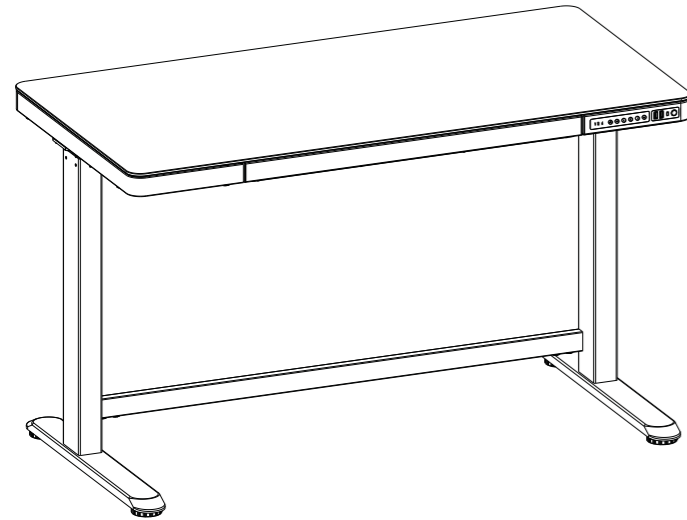

Accessory list

Attention: The drawings below are for guidance only and they may differ slightly from the product and fittings received. Please contact our customer service department should you have any queries.

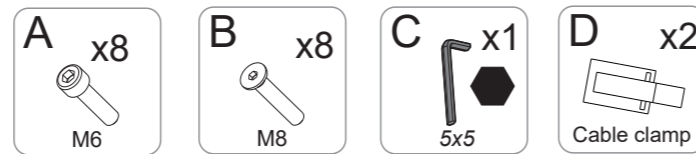

Technical data

Max. Weight Capacity	110lbs
Height Range	28.3"- 47.6"
Drawer Stroke	9"
Charging Ports/ Child Lock	

Component list

- 1. Tabletop X1
- 2. Lifting columns X1
- 3. Feet X2
- 4. Power plug X1

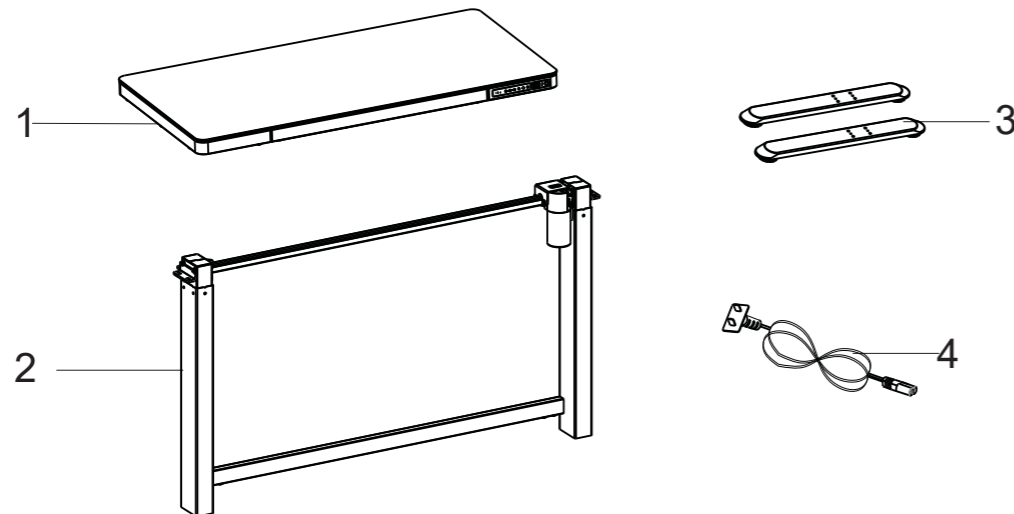

STEP 1

Install the tabletop and the lifting columns

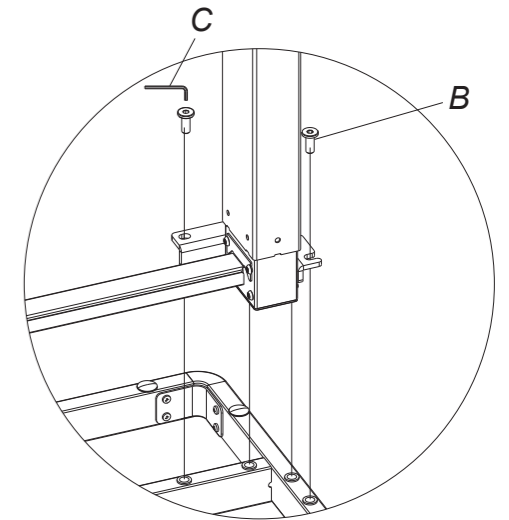
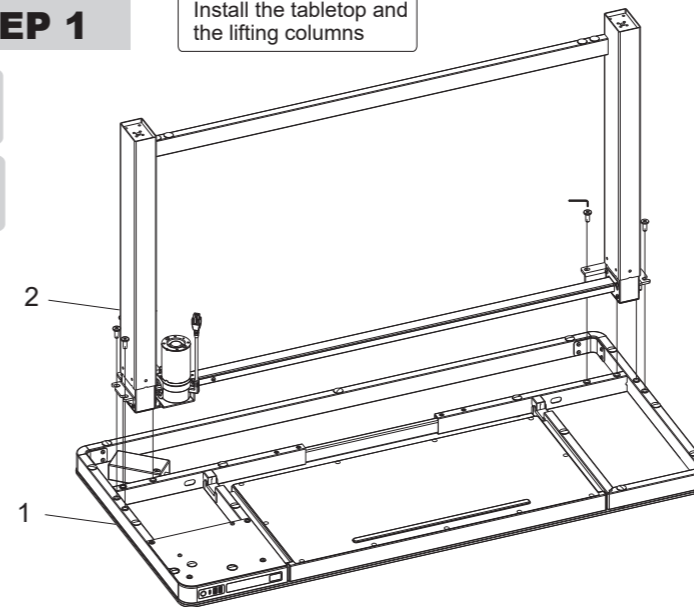

Use a hexagon allen key(C) and M8 screws to assemble the tabletop(1) and lifting columns(2).
Note: Do not touch the surface directly to the ground during installation to avoid scratching the tabletop by sharp objects.

STEP 2

Install the feet

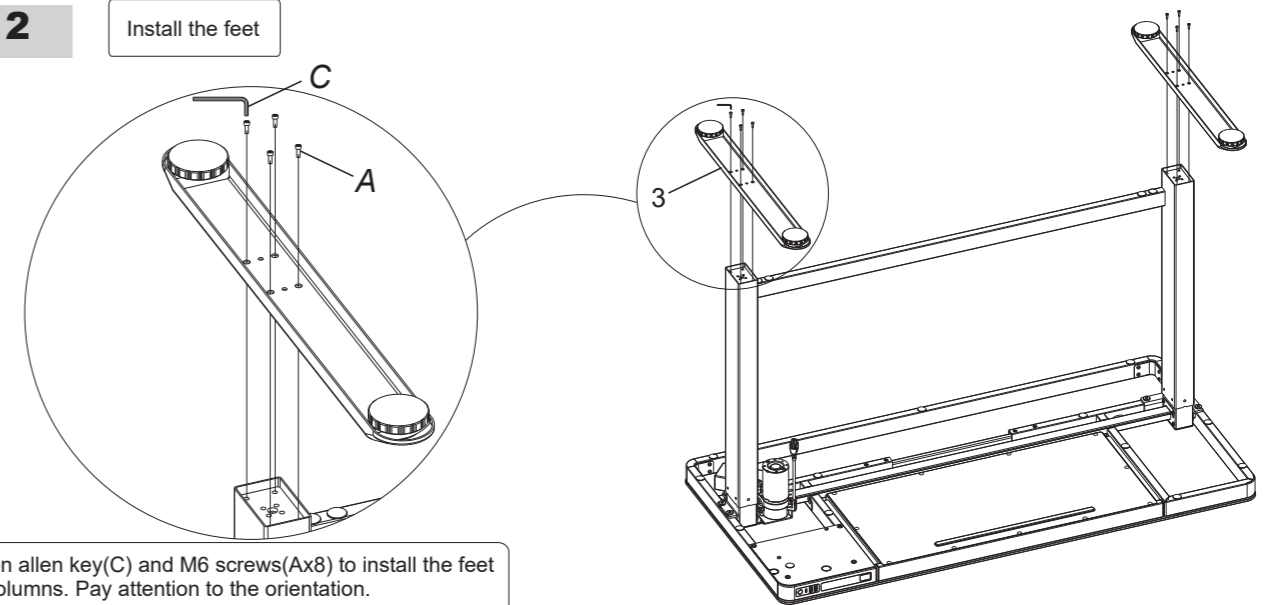

Use a hexagon allen key(C) and M6 screws(Ax8) to install the feet to the lifting columns. Pay attention to the orientation.

STEP 3

Install the motor and power lines

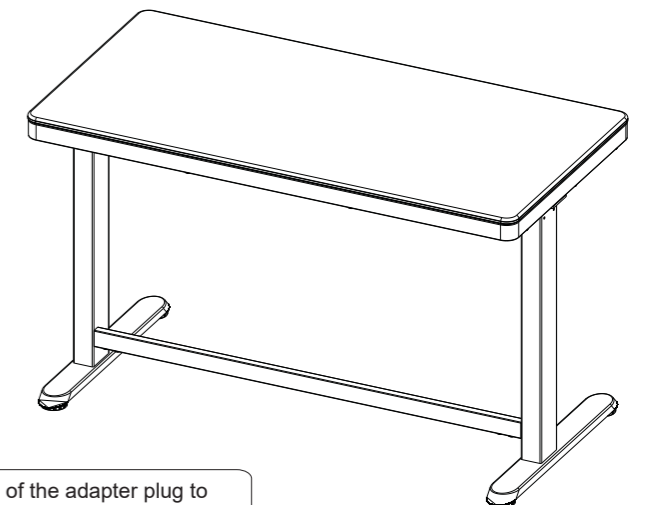
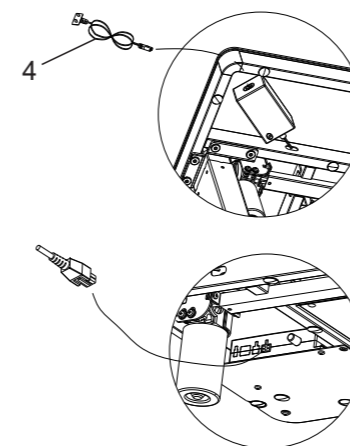

Connect the motor plug to the control box, then connect one side of the adapter plug to the adapter, another side to the power line.
Note: the motor and power lines can be fixed by cable clamp according to actual use.

Operation Instruction

Key button

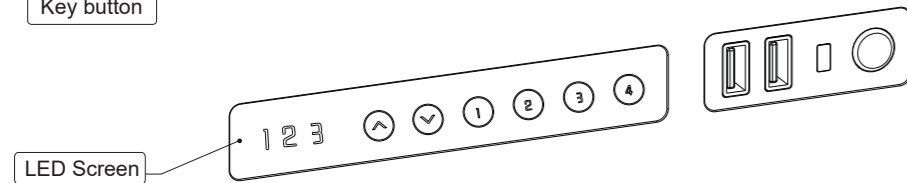

1. Touch the up/down button to adjust the height of the desk; keep pressing the up/down button for 1.2 seconds to continue adjust the height of the desk; the desktop runs to the lowest point and displays bot; the desktop runs to the highest point, displays top.
2. key button: 1,2,3,4 are the four height memory buttons, long press the button about 3s can record the current height;
3. Press the 3 and 4 buttons at the same time, long press 5 seconds, the RST reset indication will appear. Continue to press the "▼" down button until the lifting table lowers to the lowest position and rebounds to rise to a stop. The display shows the lowest height "bot", release "▼" down button, the reset is over and the table can be used normally.
4. Compatibility protocols:
TypeA port: QC2.0/3.0, Samsung AFC, Huawei FCP, BC1.2 DCP, Apple 2.4A
TypeC port: PD2.0/3.0, QC2.0/3.0, Samsung AFC, Huawei FCP, BC1.2 DCP, Apple 2.4A
Single USB port usage :
TypeA output: MAX 18W, 5V/3A, 9V/2A, 12V/1.5A;
TypeC output: MAX 45W, 5V/3A, 9V/3A, 12V/3A, 15V/3A, 20V/2.25A;
Multiple USB port usage:
1.Inserting two TypeA ports simultaneously: Output MAX 15W, shared 5V/3A;
2.Inserting one TypeA port and one TypeC port simultaneously:
TypeA port output: MAX 18W, 5V/3A, 9V/2A, 12V/1.5A;
TypeC port output: MAX 24W, 5V/3A, 9V/2.5A, 12V/2A, 15V/1.5A;
3.Inserting two TypeA ports and one TypeC port simultaneously:
TypeA port output: MAX 15W, shared 5V/3A;
TypeC port output: MAX 24W, 5V/3A, 9V/2.5A, 12V/2A, 15V/1.5A;
5. Short press the "LOCK" button to achieve the child lock function, so as to avoid accidentally touch and guarantee the safety of children;
The child lock button is switchable, screen will show "Loc" when the desk is locked.
6. Long press the up and down button to switch the sensitivity level. When the screen shows "A-0", it means the anti-collision function is off, "A-1" means the anti-collision sensitivity is in level 1, "A-2" means the anti-collision sensitivity is in level 2, "A-3" means the anti-collision sensitivity is in level 3, level 3 means the highest sensitivity.
- 7.Note: The charging function will be disabled while the height-adjustable desk is in the process of height adjustment. Once the height adjustment is stopped, the charging function will resume normal operation.

● Troubleshooting:

- a. Reset: When the LED shows "R5f", press "▼" button until the desk reaches its lowest height and rebounds to stop, it means the reset has been finished.
- b. When it doesn't work and the LED shows "E01" or "E02", please retry 18 minutes later.
- c. If the "▼" button doesn't work, please check the cable connection and then cut off the power for at least 10 seconds. Reconnect to the power and press "▼" button to start the reset process when it shows the "R5f".
- d. If all these above process are inefficient, please contact our customer service.

Common fault treatment

The following tips will help you detected and eliminate the common fault and error. If the fault you met is not listed below, please contact with your supplier. Only the manufacturer and professionals are capable for investigating

Fault phenomenon	Method
No response while long pressing down arrow after connected with a power supply	1.Check if all the cables be connected well 2.Contact your supplier or dealer
No response while pressing up arrow/ down arrow after connected with a power supply	1.Check if all the cables be connected well 2.Contact your supplier or dealer
Rising in a low speed	1. Check if overloaded, max loading: 110lbs; 2. Contact your supplier or dealer
The motor not move as instructed	1. Contact your supplier or dealer
Go down but not go up	1.Reposition 2.Contact your supplier or dealer
Downward sliding	1. Check if overloaded, max loading: 110lbs; 2. Contact your supplier or dealer
Frequently Reposition	1. Check if overloaded, max loading: 110lbs; 2. Contact your supplier or dealer
Overwork (Duty cycle: Max 2min on/18min OFF)	1. Restart after suspend for 18mins while connecting with power; 2. Contact your supplier or dealer;
Insufficient ascent and descent height	1. Press the "3" + "4" buttons at the same time for more than 3 seconds and hear the buzzer beep twice, reset again 2.Contact your supplier or distributor



Attention

1. Power supply: AC100V-240V,50/60Hz
2. Service Environment: 0-40℃
3. Unplug the power plug before cleaning, wipe the dust on surface with slight wet dishcloth when cleaning, be careful not to let the drops into the internal parts, not loose the connector.
4. The electric box contains electronic components, metals, plastics, wires etc., so dispose of it in accordance with each country's environmental legislation, not the general household waste.
5. Check carefully to ensure correct and complete assembly before using.
6. Be familiar with all functions and program settings of the product before first use.
7. Children are forbidden to play on the desk as the behavior is unpredictable. Manufacturer is not responsible for loss, injury, or damage due to those improper action.
8. Slight noise caused by the V-ribbed belt or brake system due to structure will not have any effect on the use of the equipment.
9. Corrosive or abrasive materials are forbidden to clean the equipment. Must ensure that the cleaner used will not pollute the environment.
10. This appliance can be used by children aged from 8 years and above and persons with reduced physical, sensory or mental capabilities or lack of experience and knowledge if they have been given supervision or instruction concerning use of the appliance in a safe way and understand the hazards involved. Children shall not play with the appliance.
11. Cleaning and user maintenance shall not be made by children without supervision.
12. If the supply cord is damaged, it must be replaced by the manufacturer, its service agent or a similarly qualified person in order to avoid a hazard.
13. Please make sure there is no hazard sources in your operating environment. e.g., do not litter the tools around. Always be careful to treat the packaging materials in order to avoid any possible danger, e.g. plastic bag may lead to choking hazard to children.
14. Keep the original package of the equipment if necessary in case of the future use in transportation.
15. It is forbidden to use clamping components to clamp the glass, otherwise the glass may burst and cause injury.

Waste disposal



This marking indicates that this product should not be disposed with other household wastes. To prevent possible harm to the environment or human health from uncontrolled waste disposal, recycle it responsibly to promote the sustainable reuse of material resources. To return your used device, please use the return and collection systems or contact the retailer where the product was purchased. They can take this product for environmental safe recycling.