



ELITE™

3rd Gen LED Cloud Panel



| SKU | Model |
|--------|------------------|
| 157103 | ZS-BL22-S40-3065 |
| 157110 | ZS-BL24-S72-3065 |

Beyond LED Technology's ELITE 3rd Gen Panel is a high-performing, cost-effective backlit LED panel designed to deliver ultra-thin, bright, and uniformly distributed light. As one of the most economical solutions on the market, it offers excellent energy efficiency along with adjustable wattage and CCT, making it adaptable to a wide range of lighting environments. Its sleek backlit construction produces soft, ambient lighting that enhances the look and feel of any space. With a slim profile and advanced LED technology, the ELITE 3rd Gen Panel is perfect for both retrofit and new construction applications. Ideal for commercial settings such as offices, hospitals, libraries, hotels, and corridors, it delivers reliable and affordable lighting performance. The panel features a PS lens for consistent, glare-free illumination and supports multiple mounting methods—recessed, suspended, or surface—making it a versatile lighting solution for any project.

Product Features

- Varies With Design
- Adjustable wattage
- Adjustable CCT
- 0-10V Dimmable
- 120° Beam Angle
- Super slim, durable design
- Built-in earthquake clips
- Input Voltage 110-277VAC
- ETL & DLC listed
- 5-year warranty

ELITE™

3rd Gen LED Cloud Panel



| SKU | ADJ. WATT | MAX LUMENS | ADJ. CCT | INPUT VOLTAGE | CRI | SIZE | LIGHT SPREAD | CONSTRUCTION | DIMMING | CERTIFICATIONS |
|--------|-------------------------|-----------------------|--------------------------|---------------|-----|------|--------------|--------------|---------|----------------|
| 157103 | 20W/25W/30W/ 35W/40W | Varies with Design | 3K/3500K/4K/ 5K/6500K | 100-277V | >80 | 2x2 | 120° | Metal | 0-10V | ETL & DLC |
| 157110 | 30W/40W/50W/ 60W/72W | Varies with Design | 3K/3500K/4K/ 5K/6500K | 100-277V | >80 | 2x4 | 120° | Metal | 0-10V | ETL & DLC |

SKU: 157103 / 2x2 Specifications

| Parameter | Description | Value |
|---------------------|-----------------------|-------------------------------|
| General Performance | Model # | ZS-BL22-S40-3065 |
| | Adjustable Watt | 20W/25W/30W/35W/40W |
| | Max Lumen | Varies With Design |
| | Lumen Efficacy | Varies With Design |
| | Color Temperature | 3000K/3500K/4000K/5000K/6500K |
| | CRI (Ra) | >80 |
| | Light Spread | 120° |
| | Diffuser Type | PS Cover |
| Electrical | Input Voltage | 100V-277V |
| | Frequency | 50-60Hz |
| | Dimming | 0-10V |
| | Power Factor | >0.95 |
| | Flicker Percent | Yes |
| | THD | <10% |
| Physical | Operating Temperature | -20°C to 35°C |
| | Operating Humidity | 20% - 75% |
| | Storage Temperature | N/A |
| | Storage Humidity | N/A |
| | LED Brand | Everfine |
| | LED Type | SMD2835 |
| | LED Qty. | 72 Pcs |
| Construction | Metal | |
| Qualification | Housing Color | White |
| | IP Rating | IP20 |
| | Warranty | 5 Years |

LED CLOUD PANEL



ELITE™

3rd Gen LED Cloud Panel

SKU: 157110 / 2x4

Specifications

| Parameter | Description | Value |
|---------------------|-----------------------|-------------------------------|
| General Performance | Model # | ZS-BL24-S72-3065 |
| | Adjustable Watt | 30W/40W/50W/60W/72W |
| | Max Lumen | Varies With Design |
| | Lumen Efficacy | Varies With Design |
| | Color Temperature | 3000K/3500K/4000K/5000K/6500K |
| | CRI (Ra) | >80 |
| | Light Spread | 120° |
| | Diffuser Type | PC |
| Electrical | Input Voltage | 100V-277V |
| | Frequency | 50-60Hz |
| | Dimming | 0-10V |
| | Power Factor | >0.9 |
| | Flicker Percent | Yes |
| | THD | <10% |
| Physical | Operating Temperature | -20°C to 35°C |
| | Operating Humidity | 20% - 75% |
| | Storage Temperature | N/A |
| | Storage Humidity | N/A |
| | LED Brand | Everfine |
| | LED Type | SMD2835 |
| | LED Qty | 180 Pcs |
| | Construction | Metal |
| Qualification | Housing Color | White |
| | IP Rating | IP20 |
| | Warranty | 5 Years |

ELITE™

3rd Gen LED Cloud Panel



Correlated Color Temperature (CCT)

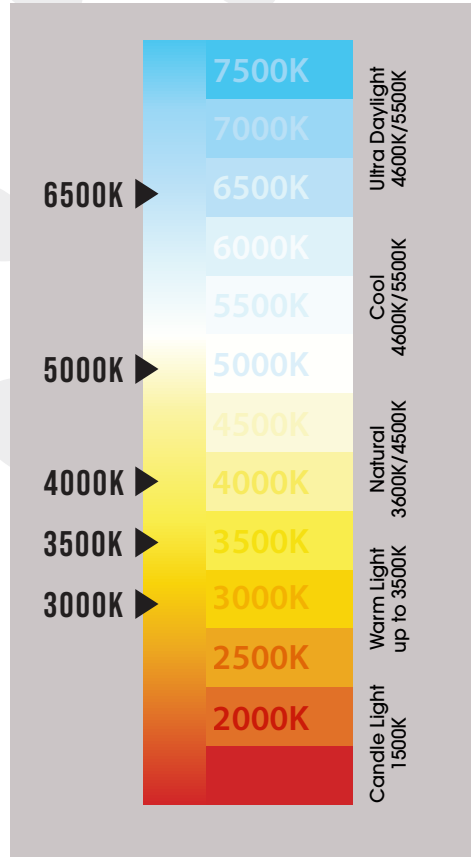

Dimensions

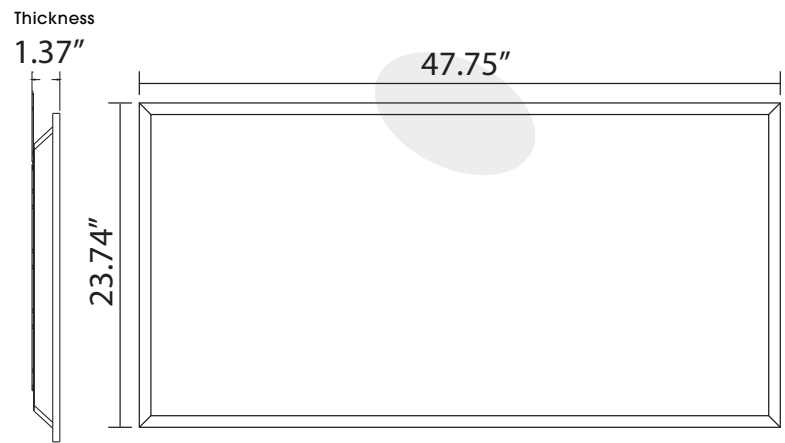
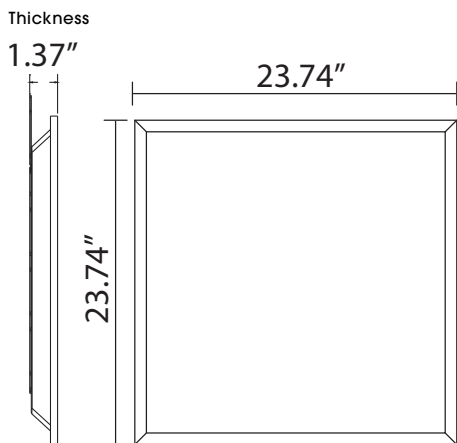

LED CLOUD PANEL



ELITE™

3rd Gen LED Cloud Panel

Distribution Diagram

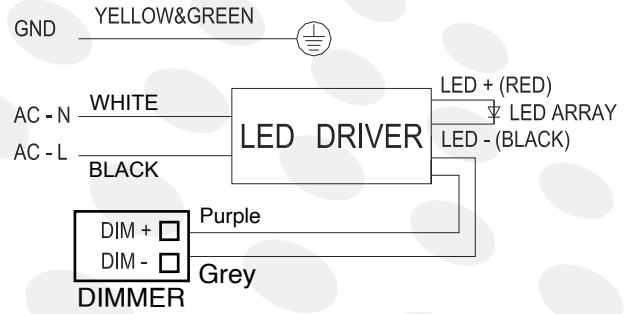
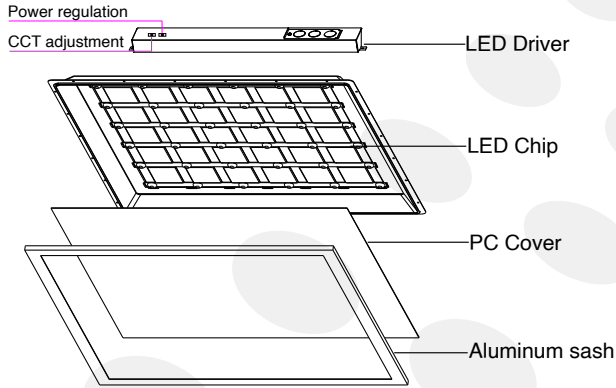

Electric Shock Attention

Ensure the power supply has been cut off before connecting the wire, and all wiring and installation of this product are required to be operated by professionals.

INSTALLATION INSTRUCTION

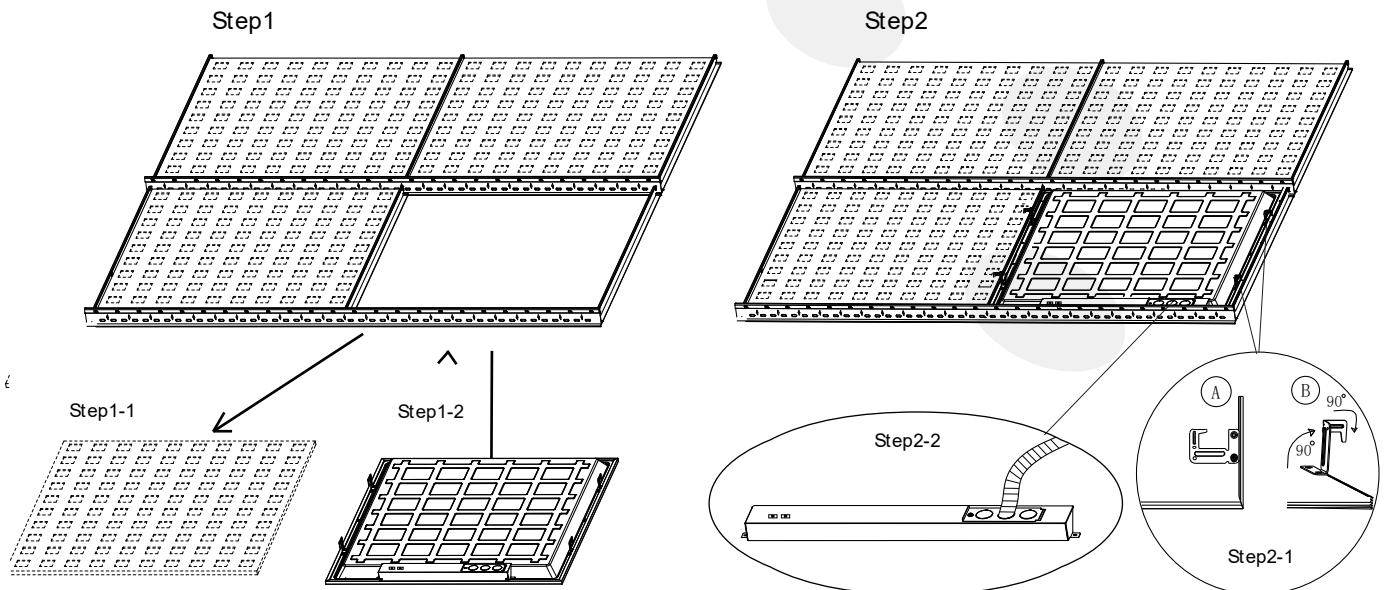

ELITE™

3rd Gen LED Cloud Panel



Installation

- Step 1:** Make sure of all the power is off before installing. Remove the one ceiling tile that you need to install light fixture on. Then place the light fixture on the T-bar carefully and make sure it is correctly in place and secure.
- Step 2:** Lift the 4 buckles on the back of the panel up by 90° then bend the top part of the buckles 90° towards the direction where you can anchor the light fixture to the T-bar.
- Step 3:** Place the driver on top of the lighting fixture in the back. Connect the cable between the driver and the lighting fixture. Open the driver's junction box and connect the AC wire to the driver correctly (L=black & N=white)

WARNING:

1. Please read the instructions carefully before installation.
2. Please make sure the power is off before installation.
3. The installation can only be done by certified electricians.
4. Product rated voltage is 100-277Volts. Please make sure voltage range meets the requirements
5. please don't use chemicals to clean the lighting surface.



ELITE™

3rd Gen LED Cloud Panel

Packaging

| SKU | Panel Size | Qty. | Box Dimensions | Net Weight | Gross Weight |
|--------|------------|-----------|-----------------------|------------|--------------|
| 157103 | 2 X 2 | 4 Pcs/Box | 25.6" X 6.1" X 25.6" | 15.5LBS | 18.7LBS |
| 157110 | 2 X 4 | 4 Pcs/Box | 49.6" x 6.10" x 25.6" | 35.3LBS | 39.7LBS |

Application Image



ELITE™

3rd Gen
LED Cloud Panel



Application Image



LED CLOUD PANEL

Warranty

This product is covered under a 5-year warranty. For complete warranty details, [Click Here.](#)