

Class 2 UL 5085-3 or ETL Recognized Transformer

Series: CL

Power Rating: **50VA**

- Class 2 Recognized UL File E49606 or ETL File 100920584CHI-001
- UL 1446 Recognized Class F 155°C Insulation System File E95662
- 50/60Hz Operation
- Factory-Installed Secondary Fuse
- Input: Hook-up Wires #18 AWG UL Style 3173, 600V, 125°C
- Output: Hook-Up Wires #18 AWG UL Style 3173, 600V, 125°C
- All leads are 12.0" L.O.C (length out of coil) 1/2" strip
- No. of Lead Wires and Color Code as per Schematic.



FRONT VIEW

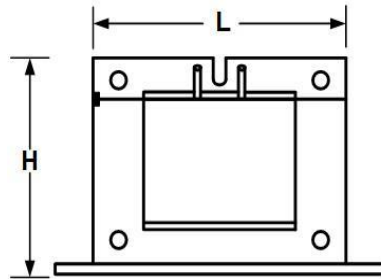

SIDE VIEW

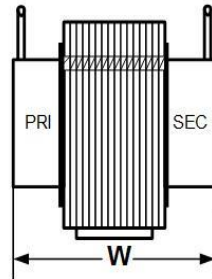

TOP VIEW

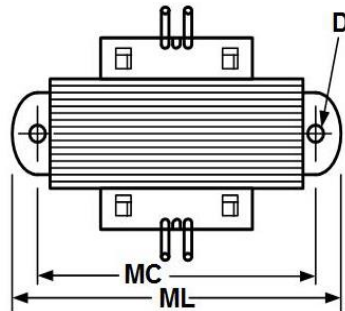

DIMENSIONS	
L	2.625"
H	2.210"
W	2.470"
MC	3.125"
ML	3.565"
MH	-
D	0.188"
B	-
C	-
F	-

UNIT WEIGHT	
Approx 0.968Lbs	

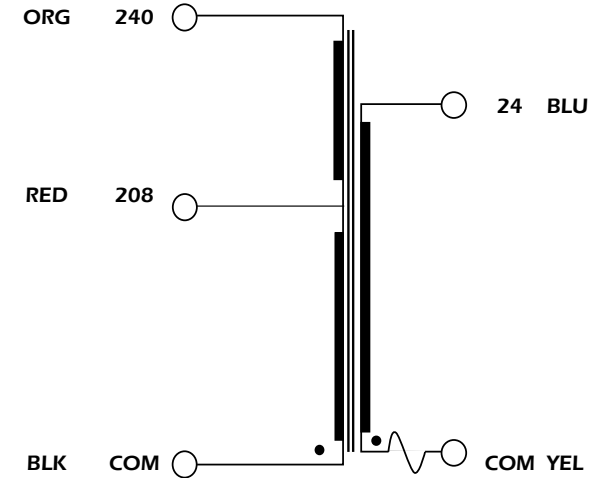

CUSTOMER P/N:



300 W Factory Road
Addison, IL 60101 USA
TEL: 630-628-9999
FAX: 630-628-9922
www.wabashtransformer.com

DESCRIPTION:

Transformer, UL Class 2 Recognized
208/240V 50/60Hz 24V 50VA

MODEL:

CL50AW15-X-HXF

0	1-Apr-2019
REV	DATE