

Mechanical Dimensions: Inches [mm]

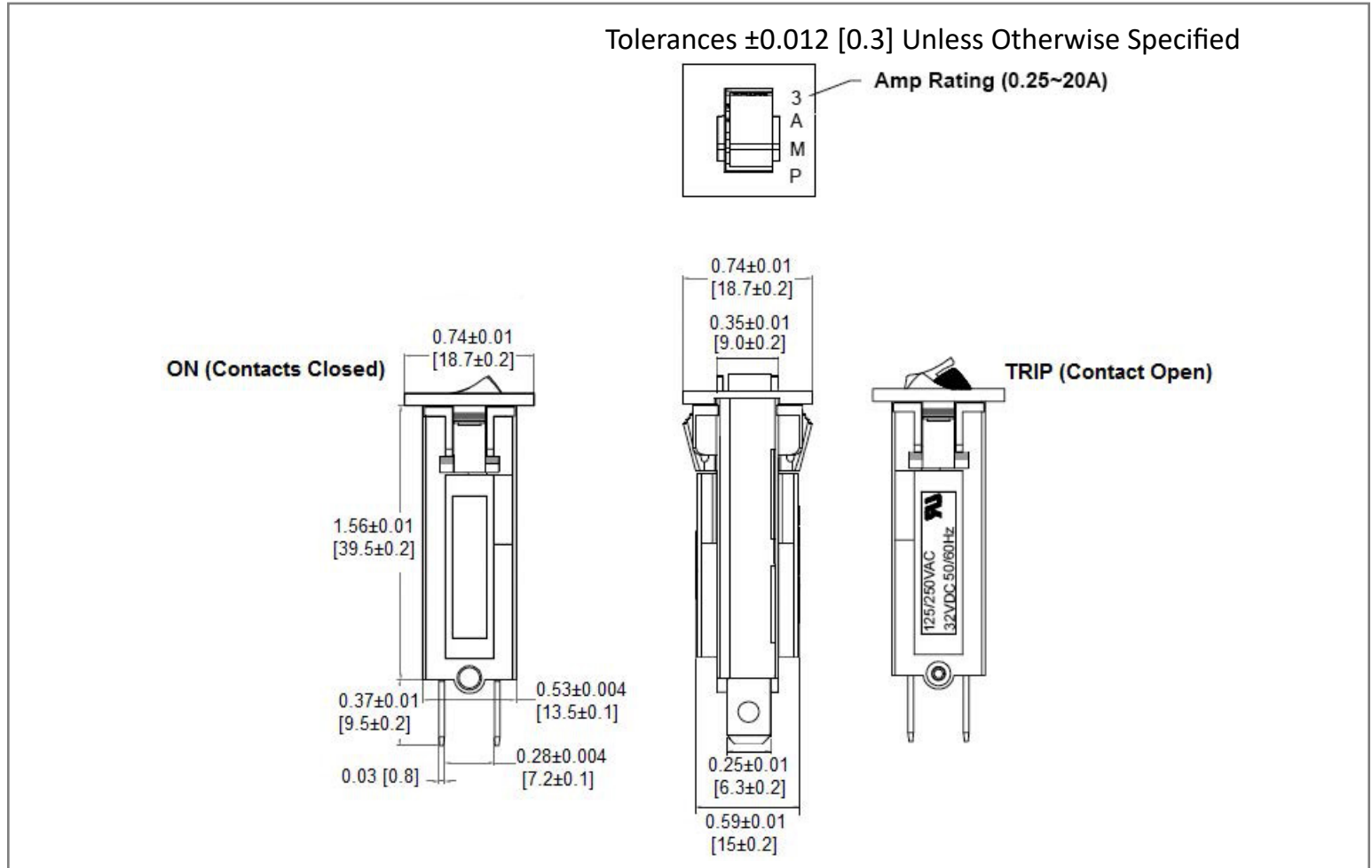

Mounting Hole

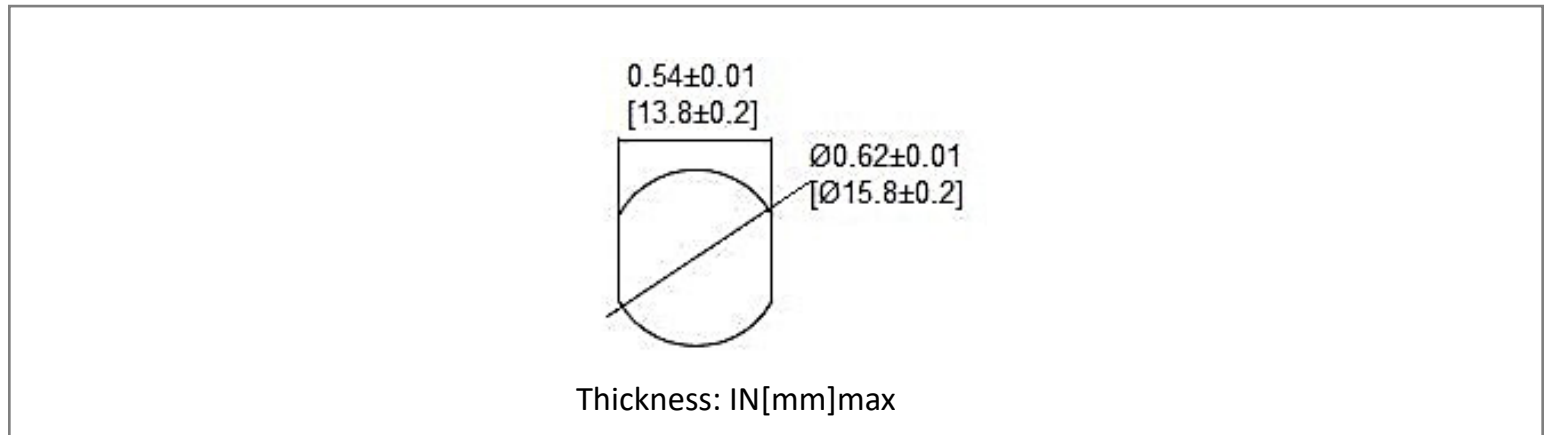

Electrical Specifications

Voltage Rating	125/250 VAC, 50/60Hz 32 VDC
Current Rating	1000A @ 250 VAC, 50/60Hz 200A @ 32 VDC
Insulation Resistance	100MΩ
Overload Capacity	6 times rated current

Material Specifications

Terminal Material	Brass, Nickel Plated
Terminal Configuration	0.250" [6.35mm] - Quick Connect
Panel Thickness	0.031"-0.083" [0.8-2.1mm]

Part Number Information

Optifuse P/N	Current
CBW-500mA	.5A
CBW28-1A	1A
CBW28-1.25A	1.25A
CBW28-1.5A	1.5A
CBW28-1.75A	1.75A
CBW28-2A	2A
CBW28-2.25A	2.25A
CBW28-2.5A	2.5A
CBW28-3A	3A
CBW28-3.5A	3.5A
CBW28-4A	4A
CBW28-5A	5A
CBW28-6A	6A
CBW28-7A	7A
CBW28-8A	8A
CBW28-9A	9A
CBW28-10A	10A
CBW28-11A	11A
CBW28-12A	12A
CBW28-13A	13A
CBW28-15A	15A
CBW28-16A	16A
CBW28-20A	20A

Time vs. Percent of Rated Current

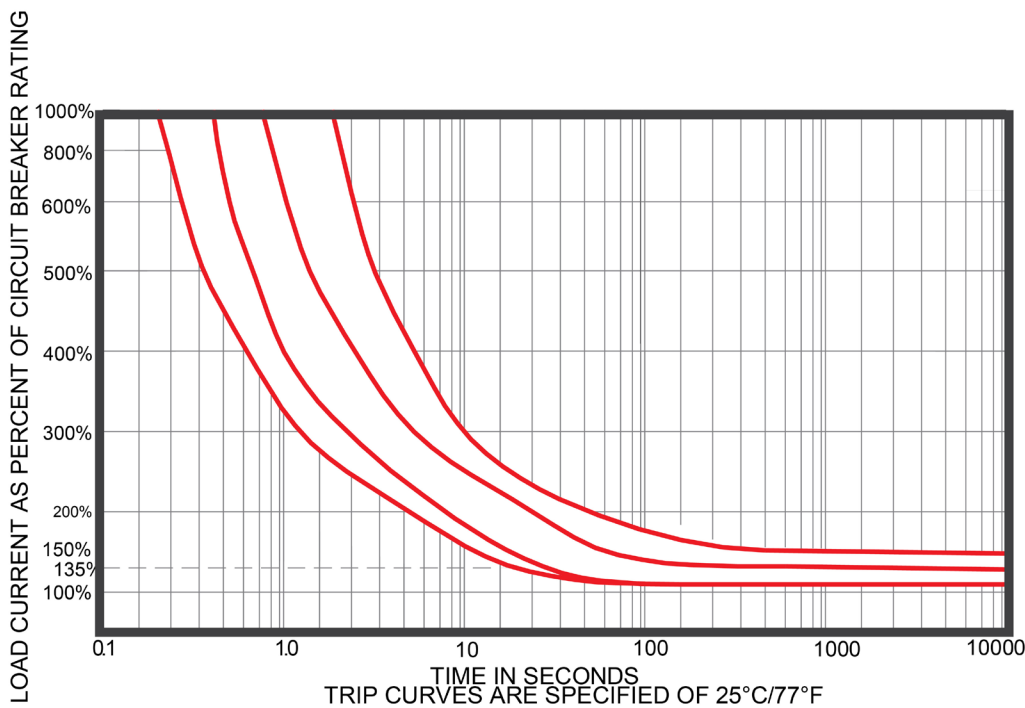

Overload	Trip Time sec	
	0.25~2.5A	3~20A
600%	0.53-3.1	0.34-1.05
500%	0.67-3.8	0.42-1.75
400%	1.0-5.5	0.62-3.05
300%	2.85-10.0	1.50-5.5
200%	7.5-52.0	5.2-30.0
150%	Trip in 1 Hour	-
135%	-	Trip in 1 Hour
100%	Hold, No Trip	

Temperature Derating Table

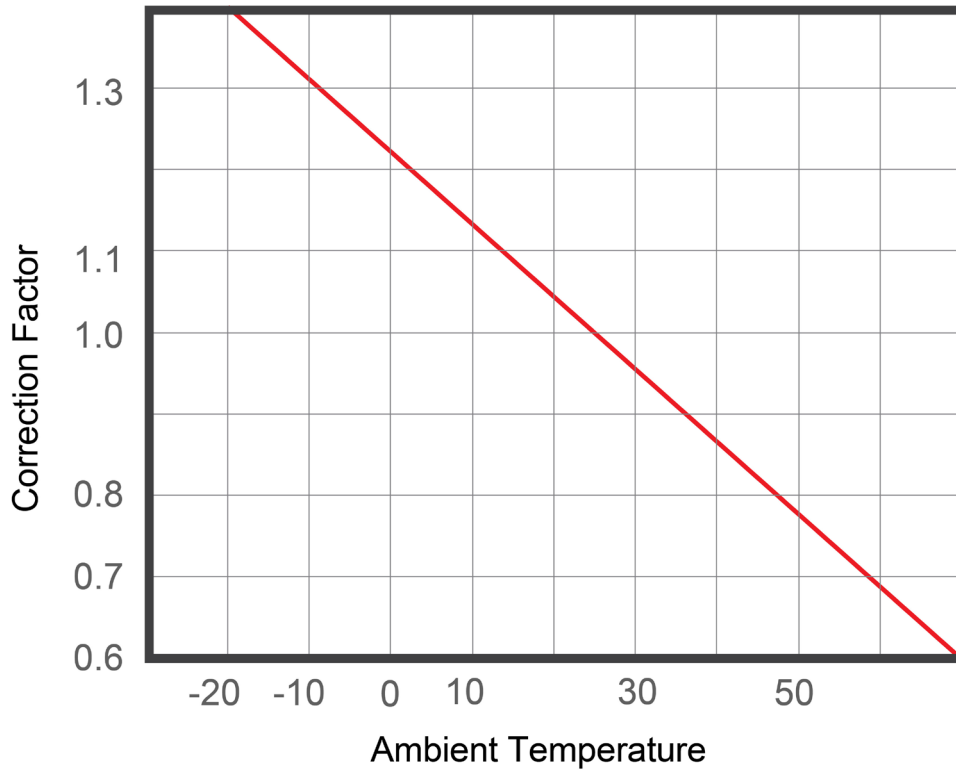

Rev	Date of issue	Revision Notes	Designed	Approved
H	09-05-2025	Updated Amperage Ratings	RC	OF