

Steel square covers

4¹¹/₁₆" SQUARE COVERS – CUBIC INCH CAPACITY (SEE BELOW)

UL LISTED



TP568

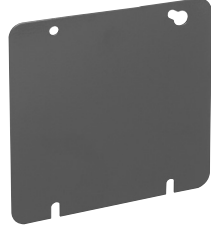

TP568RED, TP568BLUE

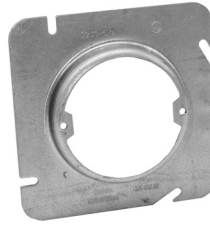

TP569, TP570, TP571,
TP573, TP575



TP572



TP574 - TP582,
TP529, TP531

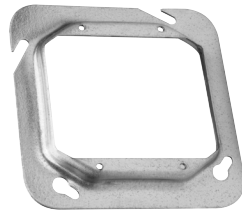

TP584, TP586, TP589,
TP593, TP541, TP543

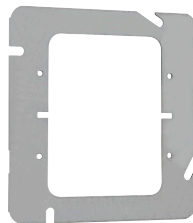

TP584, TP586, TP589,
TP593, TP541, TP543



TP851^B



TP852^B

Cat. #	Description	Capacity cu. in.	Unit qty.	Wt. lbs. per 100
Flat and raised				
TP568 ^H	Flat blank	-	25	40
TP568RED	Flat blank, red	-	25	40
TP568BLUE ^C	Flat blank, blue	-	25	40
TP569 ^{C G}	1/2" raised, with ears 2 1/4"	3.5	25	25
TP570 ^C	5/8" raised, with ears 2 1/4"	4.8	25	31
TP571 ^{C G}	3/4" raised, with ears 2 1/4"	5.4	25	40
TP572 ^H	Flat, with 1/2" KO	-	25	40
TP573 ^{C G}	1" raised, with ears 2 3/4"	6.5	25	40
TP575 ^{C G}	1 1/4" raised, with ears 2 3/4"	9.5	25	45
Air plenum				
TP851 ^B	Flat blank gasketed with captive screws	-	50	42
TP852 ^B	Flat ring double gasketed	-	25	20
One device				
TP574 ^H	1/4" raised	1.8	25	32
TP576 ^{C H}	1/2" raised	3.5	50	31
TP579 ^H	5/8" raised	4.5	25	39
TP578 ^{C H}	3/4" raised	5.5	25	31
TP580 ^H	1" raised	6.8	25	46
TP582 ^H	1 1/4" raised	8.5	25	52
TP529 ^H	1 1/2" raised	11.3	25	64
TP531 ^H	2" raised	15.0	25	76
Two device				
TP590 ^C	Flat	-	50	19
TP583 ^{H G}	1/4" raised	3.0	25	26
TP584 ^H	1/2" raised	6.0	25	30
TP587 ^C	5/8" raised	7.3	25	25
TP586 ^H	3/4" raised	8.8	25	34
TP589 ^C	1" raised	11.5	25	38
TP593 ^C	1 1/4" raised	15.0	25	38
TP541 ^H	1 1/2" raised	18.8	25	63
TP543 ^{C H}	2" raised	24.5	25	79

^B For air plenum (no mounting holes) - not UL Listed.
^C cUL Listed.
^H CSA certified.
^G Not UL Listed.