

URINAL BOWL CLEANING INSTRUCTIONS

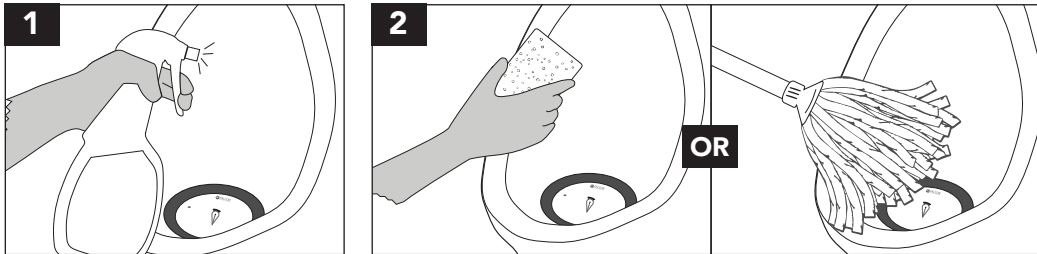

Spray (mist) cleaner on the entire bowl. Clean outside and inside of bowl with rag, sponge, or mop.

WHEN SHOULD A CARTRIDGE BE CHANGED?

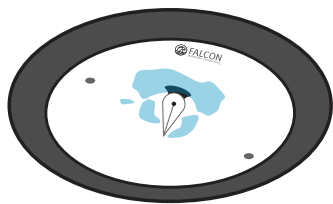

Blue sealant appears on top of the cartridge

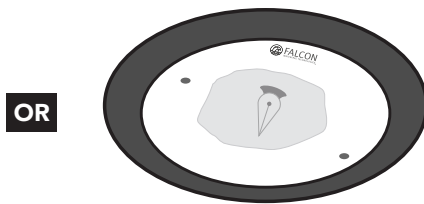

Fluid flows very slowly into the cartridge



Fluid does not drain into the cartridge

C1M2+ CARTRIDGE CHANGING INSTRUCTIONS

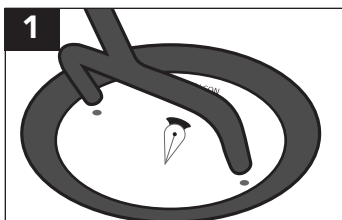

Insert key into cartridge.



Turn key to left to unlock.

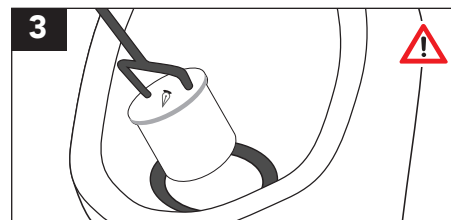

Lift and tilt cartridge to drain all free liquids then spray Falcon Foam Housing Cleaner into housing.



Place cartridge into bag, tie bag to seal and dispose.



CAUTION After removing cartridge from housing, certain naturally occurring but **potentially hazardous sewer gases** may escape through the opening until re-installed properly. If replacement cartridge will not be re-installed immediately, place a rag or paper towels into opening to block any sewer gases. Remove the paper towels or rag prior to inserting new cartridge. Alternatively, use Falcon Foam Housing Cleaner to both clean housing and reduce any outflow of sewer gases through open housing during cartridge change. **Never smoke, have an open flame, or place your nose or mouth near waterless urinal housings into which a cartridge is not yet properly installed.** You also can wear a breathing mask when removing or installing any waterless urinal or cartridge to reduce potential exposure to any such gases.

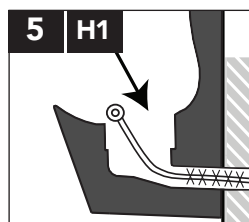

Scrub the housing and deep inside of the tailpipe with a long 1.5-inch diameter nylon brush.

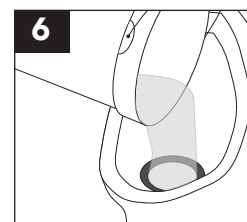
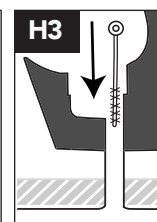

Flush housing with 5 gallons (20 liters) of hot soapy water.



Wipe clean inner stainless steel rim.



Insert new cartridge into housing and turn key to right to lock and click into place.

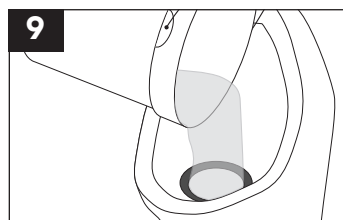

Slowly fill cartridge with 1 quart (1 liter) or more of clean water until there are no air bubbles.

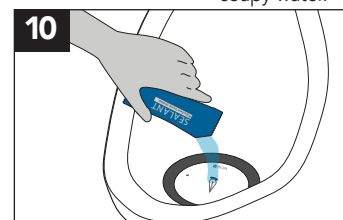

Add blue sealant (allow time to drain into cartridge).

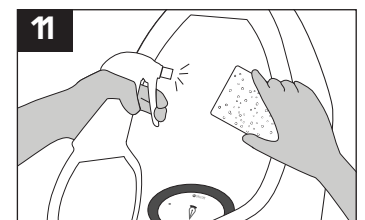

Spray (mist) bowl with cleaner and wipe clean.

INSTRUCCIONES PARA LIMPIAR EL URINARIO

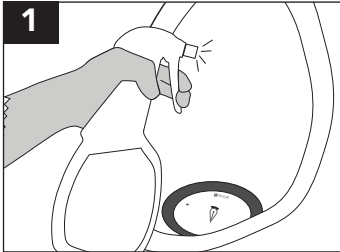

Rociar el orinal/urinario/mingitorio con el líquido limpiador.

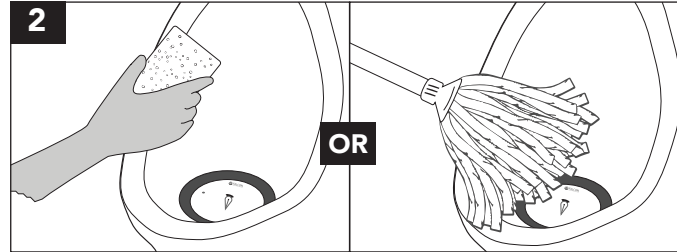

Limpiar la parte exterior y por todo el interior del orinal/urinario/mingitorio.

CUÁNDO SE DEBE CAMBIAR EL CARTUCHO?

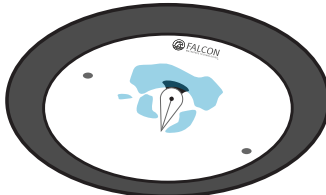

El sellador azul aparece alrededor del protector

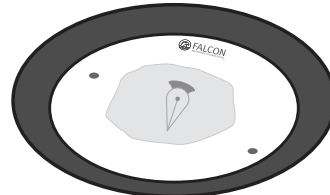

El líquido pasa lentamente por el cartucho

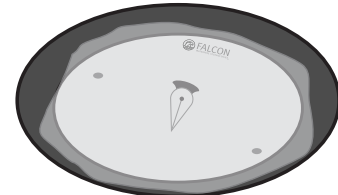

El líquido no desagua en el cartucho

INSTRUCCIONES PARA CAMBIAR DEL CARTUCHO C1M2+

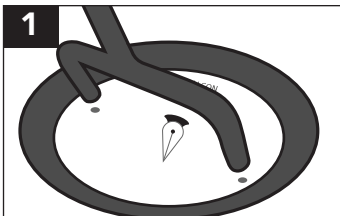

Insertar la llave en el cartucho.



Girar la llave hacia la izquierda para destrabar el cartucho.

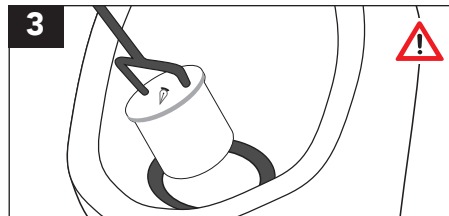

Levanta e inclina el cartucho para drenar líquidos, después aplique la espuma limpiadora Falcon dentro del contenedor del cartucho.

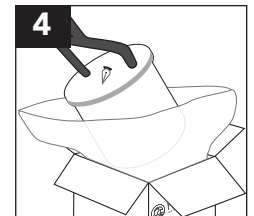

Colocar el cartucho usado en la bolsa, sellar y desechar.



Atencion!! Una vez sacado el cartucho del receptáculo, pueden escaparse gases tóxicos del desagüe hasta que el nuevo cartucho este instalado.

Si no reinstala el cartucho inmediatamente después, bloquee temporalmente el desagüe para evitar que los gases se expandan. Cuando vaya a instalar el nuevo cartucho, saque el bloqueo que utilizo para evitar la fuga de gases y pase a reinstalar el nuevo cartucho. Nunca fume, acerque una llama o se acerque más de lo estrictamente necesario al desagüe si el cartucho no está instalado. **Se recomienda usar mascarilla cuando vaya a cambiar un cartucho, así evitara los gases y lo malos olores.**

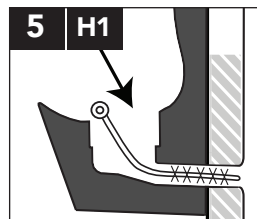

Cepile el contenedor del cartucho, y hacia dentro del tubo escape o evecuación con un cepillo de 1.5 pulgadas de diámetro con cerdas de nylon.

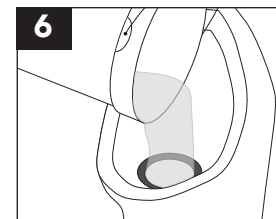
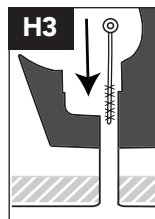

Lavar el contenedor de cartucho con 5 galones o 20 litros de agua caliente jabonosa.

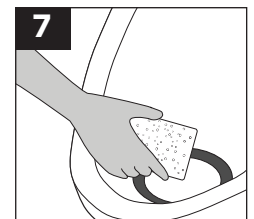

Limpiar la parte interior del anillo de acero inoxidable.

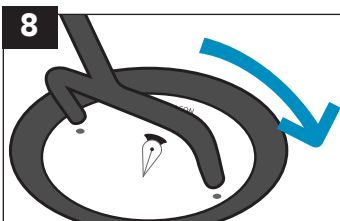

Poner el nuevo cartucho en el orificio y girar la llave hacia la derecha para que queda trabado.

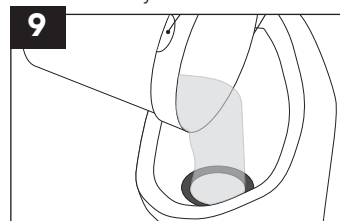

Rellene despacio el cartucho con un litro de agua limpia hasta que no quede ni aire ni burbujas.

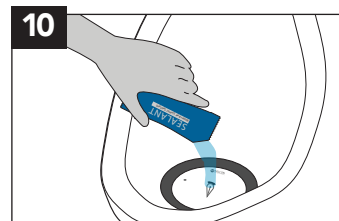

Añadir el sellador azul (dando tiempo a que desagüe en el cartucho).

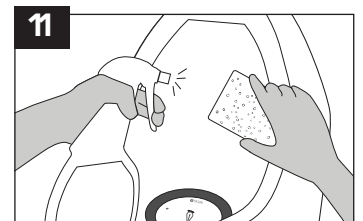

Rociar el orinal/urinario/mingitorio con el líquido limpiador y limpiarlo.

LA CUVETTE INSTRUCTIONS DE NETTOYAGE

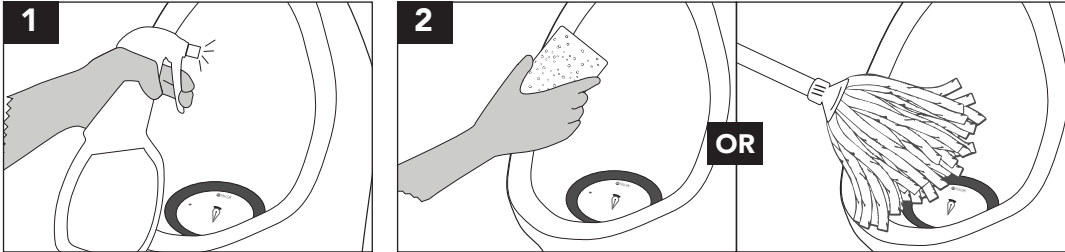

1 Vaporiser (brume) la cuvette avec un produit de nettoyage recommandé par Falcon.

2 Essuyer complètement l'extérieur et l'intérieur de la cuvette puis replacer le couvercle déflecteur.

QUAND FAUT-IL CHANGER UNE CARTOUCHE ?

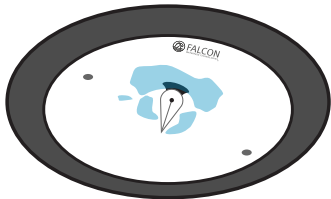

Lorsque le liquide occlusif bleu devient visible autour du couvercle déflecteur

OU



Lorsque l'urine ne s'écoule que très lentement dans la cartouche

OU

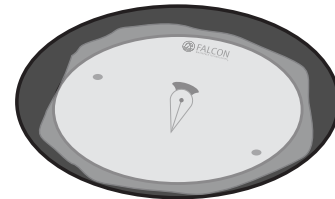

Lorsque l'urine ne passe plus du tout dans la cartouche

C1M2+ CARTOUCHE INSTRUCTIONS POUR LE CHANGEMENT

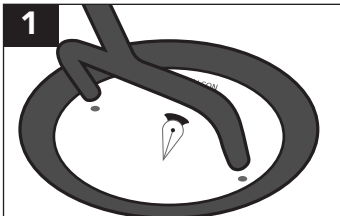

1 Insérer les broches de l'outil dans la cartouche.



2 Tourner l'outil vers la gauche pour déverrouiller.

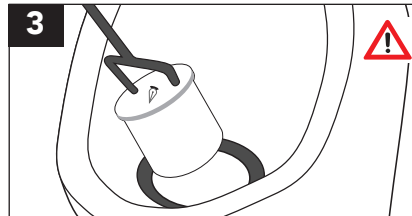

3 Soulever, tourner et incliner la cartouche pour la vider. Appliquer le nettoyeur-mousse (Falcon Foam Housing Cleaner) dans le boîtier.

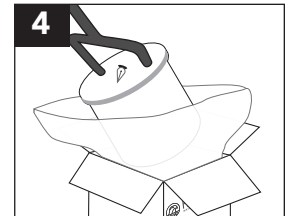

4 Placer la cartouche usagée dans le sac de plastique prévu, sceller et en disposer.



CAUTION After removing cartridge from housing, certain naturally occurring but **potentially hazardous sewer gases** may escape through the opening until re-installed properly. If replacement cartridge will not be re-installed immediately, place a rag or paper towels into opening to block any sewer gases. Remove the paper towels or rag prior to inserting new cartridge. Alternatively, use Falcon Foam Housing Cleaner to both clean housing and reduce any outflow of sewer gases through open housing during cartridge change. **Never smoke, have an open flame, or place your nose or mouth near waterless urinal housings into which a cartridge is not yet properly installed.** You also can wear a breathing mask when removing or installing any waterless urinal or cartridge to reduce potential exposure to any such gases.

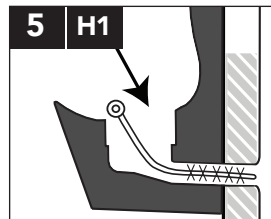

5 Nettoyer le boîtier et le tuyau de sortie avec une brosse de nylon de 38 mm (1,5 pouces) de diamètre munie d'un long manche.

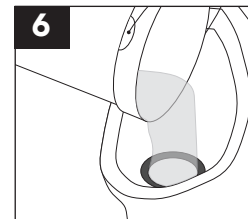
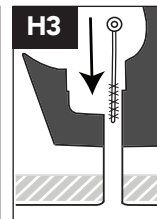

6 Verser 5 gallons ou 20 litres d'eau chaude savonneuse.

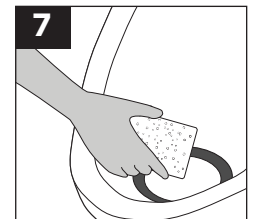

7 Nettoyer la jante intérieure en acier inoxydable.



8 Insérer la cartouche neuve dans le boîtier et tourner l'outil vers la droite pour verrouiller.

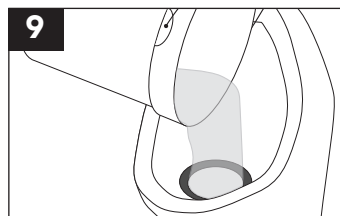

9 Le couvercle déflecteur enlevé, emplir la cartouche avec un litre d'eau propre ou plus, jusqu'à ce qu'il n'en sorte plus de bulles d'air.

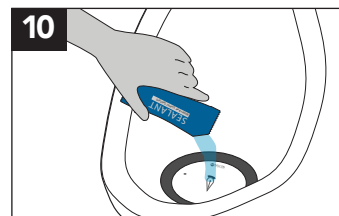

10 Ensuite seulement, y verser le liquide occlusif bleu et attendre qu'il disparaisse dans la cartouche.

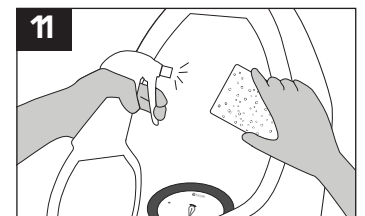

11 Vaporiser (brume) la cuvette avec un produit de nettoyage et essuyer.