



SNAP BRIGHT™

Retrofit Downlight



SKU #	Model #
156992	FXF01068

Beyond LED Technology's SNAP BRIGHT Retrofit Downlight is a high-performance, energy-efficient lighting solution designed for both residential and commercial spaces. This 6" downlight offers five selectable CCT options and smooth Triac dimming, providing customizable illumination to suit any setting. Its sturdy butterfly clips ensure a secure, tool-free installation, making it an ideal choice for quick and easy upgrades. The flicker-free design enhances visual comfort, while the sleek white housing seamlessly integrates into any ceiling. With E26 quick connector and junction box compatibility, the SNAP BRIGHT Retrofit Downlight makes installation fast and effortless. Perfect for a variety of applications, the SNAP BRIGHT Retrofit Downlight is ideal for use in kitchens, living rooms, offices, retail spaces, hotel lobbies, bathrooms, and other indoor areas that require efficient, high-quality lighting.

Product Features

- Up to 100 lm/W
- 12 Watt
- Adjustable CCT
- Available in 6"
- Triac dimming
- 110° Beam Angle
- White housing
- Input Voltage 120VAC
- ETL listed
- 2-year warranty

SNAP BRIGHT™

Retrofit Downlight



SKU	WATT	MAX LUMENS	ADJ. CCT	INPUT VOLTAGE	CRI	SIZE	LIGHT SPREAD	CONSTRUCTION	DIMMING	CERTIFICATIONS
156992	12W	1200	2700K/3K/3500K/4K/5K	120V	>90	6"	110°	Aluminum+PC Lens	Triac	ETL

SKU: 156992 / 6"

Specifications

Parameter	Description	Value
General Performance	Model #	FXF01007
	Watt	12W
	Max Lumen	1200
	Lumen Efficacy	Up to 100LM/W
	Color Temperature	2700K / 3000K / 3500K / 4000K / 5000K
	CRI (Ra)	≥80
	Light Spread	110°
	Diffuser Type	PC Lens
Electrical	Input Voltage	120Vac
	Frequency	50/60Hz
	Dimming	Triac Dimmable
	Power Factor	≥0.7
	Driver Surge Protection	N/A
	Flicker Percent	Flicker Free
Physical	Operating Temperature	-20°C ~ +45°C
	Operating Humidity	≤80%RH
	Storage Temperature	-20°C~65°C
	Storage Humidity	≤95%RH
	LED Brand	Everlight
	LED Type	2835
	LED QTY	48+48 PCS
Construction	Aluminum	
Qualification	Housing Color	White
	IP Rating	Damp Location
	Warranty	2 Year Warranty

RETROFIT DOWNLIGHT



SNAP BRIGHT™

Retrofit Downlight

Correlated Color Temperature (CCT)

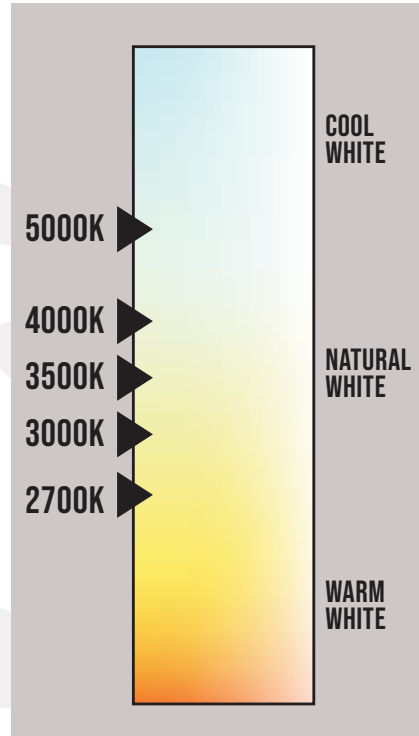

Dimensions

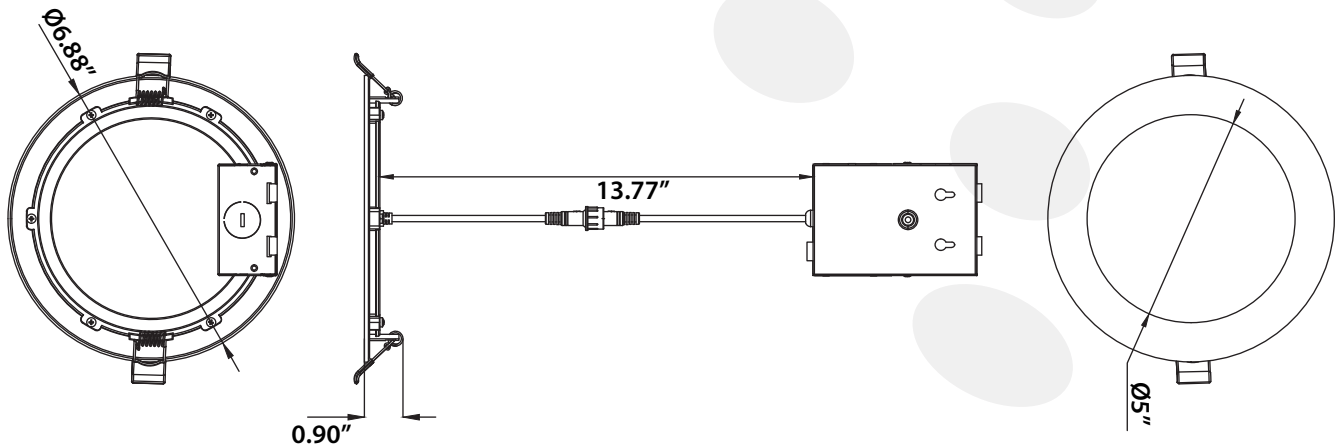

SNAP BRIGHT™

Retrofit Downlight



Photometric Data

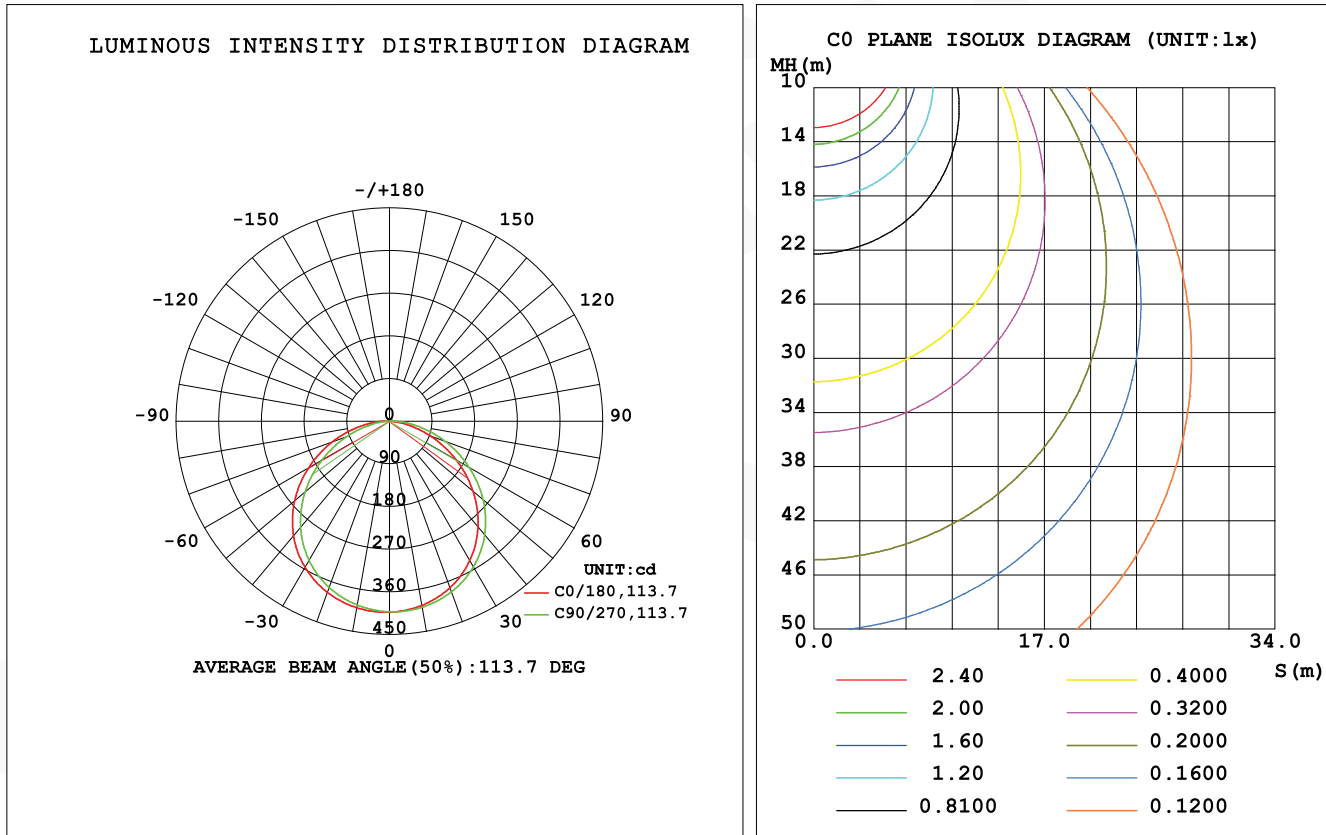

C Range: 0 - 360DEG
 C Interval: 90.0DEG
 Test Speed: HIGH
 Temperature: 25.3DEG
 Operators:
 Test Date: 24 April 2024

γ Range: 0 - 180DEG
 γ Interval: 0.5DEG
 Test System: EVERFINE GO-2000A_V1 SYSTEM V2.0.350
 Humidity: 55.0%
 Test Distance: 8.852m [K=1.0000]
 Remarks:

RETROFIT DOWNLIGHT



SNAP BRIGHT™

Retrofit Downlight

Installation

1. Turn Off power from the electrical panel prior to installation.
2. Determine the location where you want to install the fixture and cut a hole in the ceiling according to the template in the box (fig. 1).
3. Open the junction box cover and remove the appropriate knockout(s) on the side panel (fig. 2).
4. Insert the electrical supply cable through the knockout and secure with a cable connector.
5. Using quick-connect push-in terminals, connect the ground wire to the ground wire terminal; black wire to black wire terminal; white wire to white wire terminal (fig. 2).
6. Place all wiring and connections back into the junction box and close the cover. Connect the junction box to the light panel with the quick connect system.
7. Insert the junction box through the mounting hole (fig. 3).
8. Push clips on the fixture upwards and insert fixture base into the mounting hole. Release the clips and fixture will be pulled flush to the ceiling (fig. 4).

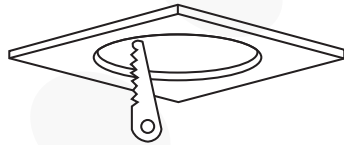

Cut - Hole Size
6" Round Ø6 1/4" (Ø158mm)

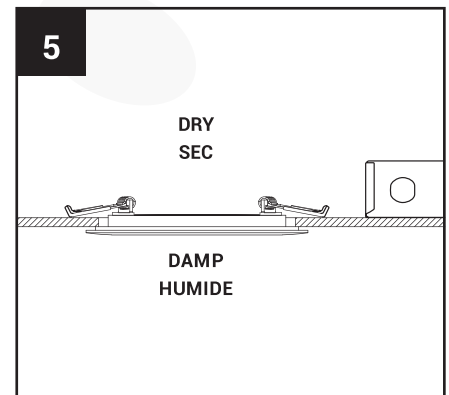
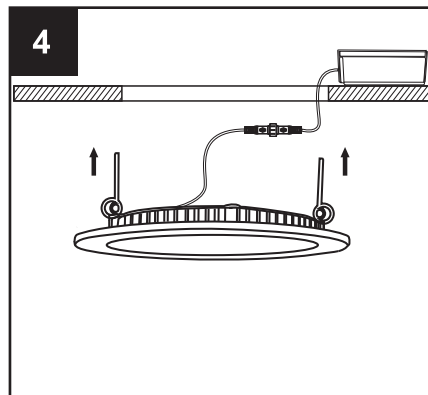
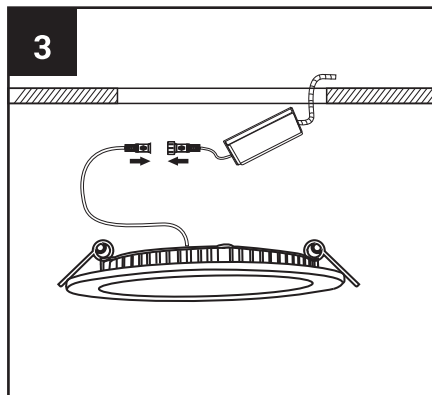
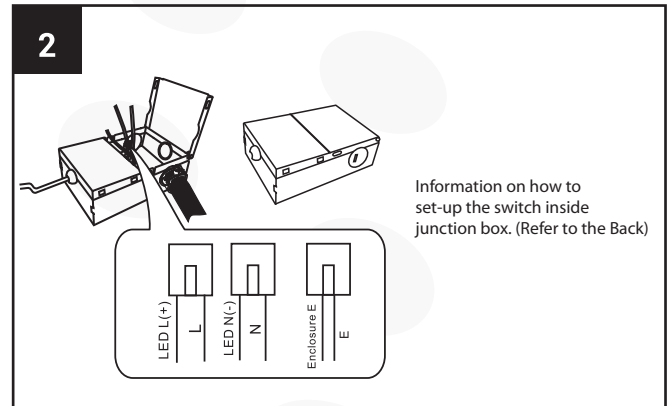
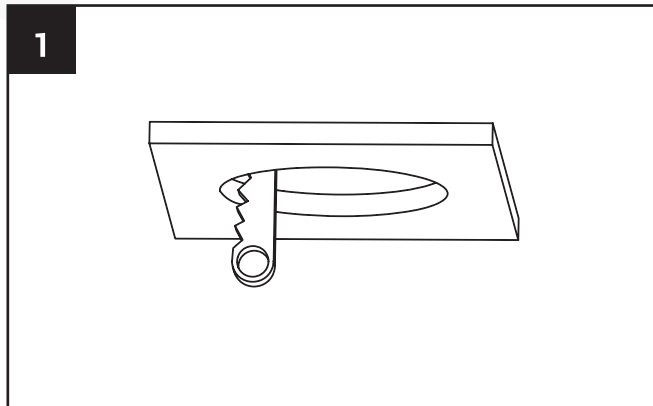

SNAP BRIGHT™

Retrofit Downlight



Installation

Information on how to set-up the switch inside junction box

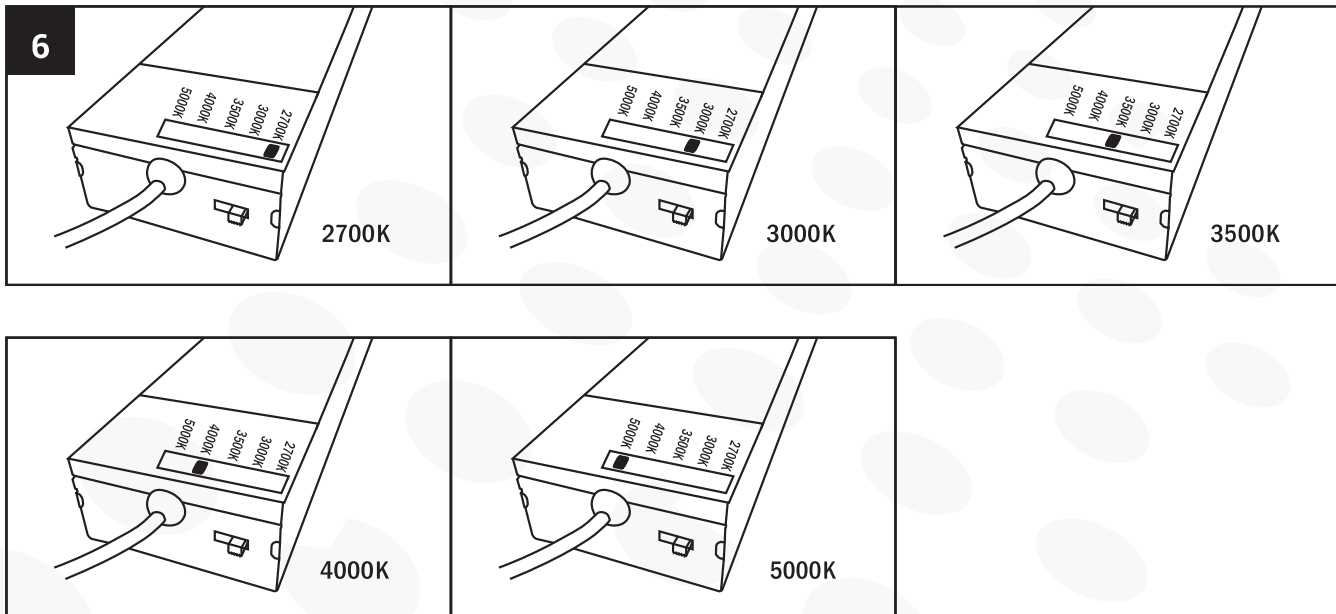

- You can choose the temperature of the light (from soft to cold) from a switch inside the junction box and maintain that temperature



SNAP BRIGHT™

Retrofit Downlight

Packaging

SKU	Box Type	Box Dimension	Qty	Net Weight	Gross Weight
156992	Inner Box	7.08" x 2.95" x 7.08"	4 Pcs/Box	1.6041LBS	1.8246LBS
	Outer Box	13.19" x 7.48" x 10.82"	12 Pcs/Box	9.26LBS	10.78LBS

Application Image



RETROFIT DOWNLIGHT

SNAP BRIGHT™

Retrofit Downlight



Application Image



RETROFIT DOWNLIGHT

Warranty

This product is covered under a 5-year warranty. For complete warranty details, [Click Here.](#)