

# M2/M2pro

## Quick Start Guide

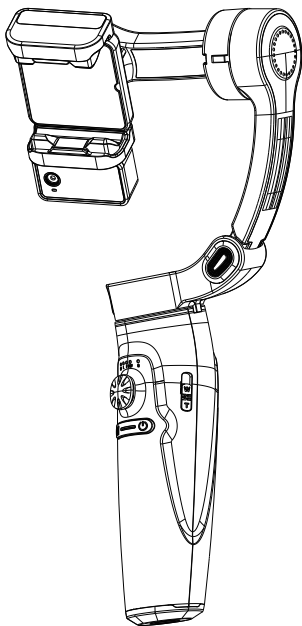

Merak Two pro

## 1. Preparation

- ios: Search for "Gimbal Play" in the APP Store  
Android: Search for "Gimbal Play" in the Google App



Scan code to download "Gimbal Play" app

### Bluetooth connection:

When using the APP the Bluetooth name M3 will pop up in the APP. Click to confirm pairing. When using the native camera, search for the Bluetooth name M3 in Settings-Bluetooth and click to connect and pair.

## 2. Recognition stabilizer

This product is a three-axis stabilizer specially designed for mobile phones. It can assist mobile phones in shooting, effectively eliminate the picture shake caused by the external environment in the shooting process, and provide stable and smooth images. The stabilizer operation is simple and clear, the elderly and children can get started, can meet all the hobby of mobile phone photography crowd use. The stabilizer can support horizontal and vertical shooting of the mobile phone and can control the direction button to manually adjust the shooting angle of the mobile phone, to meet the requirements of shooting and video production.

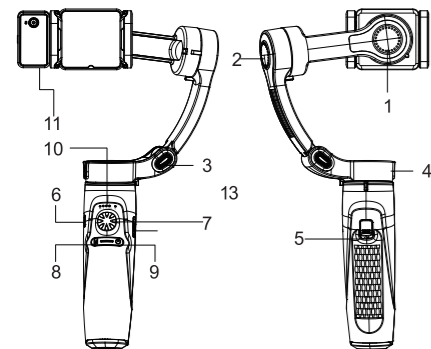

1. Roll axis
2. Pitch axis
3. Zoom
4. Course axis
5. Photo
6. Type-C charging port
7. Direction
8. Mode
9. Power
10. Indicator light  
PF: semi-following mode  
L: lock mode  
F: Full follow mode  
POV: pov mode  
Q: Battery display
11. AI module

## 3. Charging

Use the standard USB Type-C data cable to connect to the USB charger to charge the gimbal. During charging, all display lights flash from right to left in a cycle, and all lights turn on when fully charged.

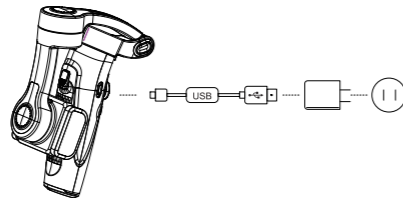

## 4. Installing a Mobile Phone

Unfold the cradle head and release the locking state of pitch shaft, heading shaft and phone clip.

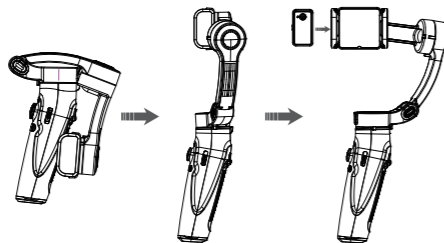

## 5. Adjustment balance

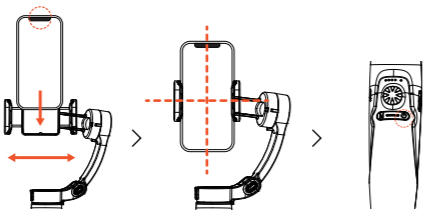

1. The phone clip stretches from side to side, Phone lens facing up.
2. Place the phone in the center of the clamp.
3. Press and hold the power button for 3 seconds to power on.

## 6. Function of the button

- Power Button**  
Press and hold for 3 seconds to power on/off.  
Click to switch between horizontal and vertical shots.  
Double-click to center/reset.
- M-Mode**  
Click the pov mode four times/push the direction keys up and down in the pov mode to achieve the Inception mode.
- Joystick**  
Use the joystick to control the gimbal's movement in four directions (up, down, left, and right), allowing for easy angle adjustments while shooting.
- Trigger/photo**  
Click the camera button to take photos/record videos.  
Double-click the camera button to switch between the front and rear lenses of the phone.  
Triple-click the photo button to take a photo - video exchange.  
Long press the camera button to record directly.
- Focusing**  
Push upwards (W direction) in the app to zoom in.  
Push downwards (T direction) in the app to zoom out.
- Battery Q Indicator**  
The Q light is always green and the battery has sufficient power.  
The Q light flashes green, battery power is medium.  
The Q light is always on red, the battery is low and needs to be charged.
- Indicator light**  
PF: Half following mode, yaw axis motor follows.  
F: Full following mode, yaw axis motor and tilt axis motor follow.  
POV: Pov mode, three motors follow at the same time.

## 7. AI module gesture



When the AI tracking module is installed, face the camera and gesture

Note: After switching between landscape and portrait modes, the AI module will enter a tracking stop state. You need to make the "OK" gesture again to reactivate tracking.

## 8. Specification

Charging Voltage	5V
Charging Current	<2000mA
Working Current	200-2000mA
Working Voltage	3.7V
Working Temperature	-10°C-40°C
Working Time	5-8hours
Net Product Weight	M2 : 577.3g , M2pro : 593.1g
Applicable Models	Below 7 Inches
Load Weight	280g
Lithium-ion Battery	2500mAh
Roll Axis Range of Motion	-100°~+220°
Pitch Axis Range of Motion	-45°-45°
Yaw Axis Range of Motion	-160°-160°
Accessory Interface	1/4 Inch Thread Interface

## 9. Folding

- Fold the head and release the locking state of pitch shaft, heading shaft and phone clip.

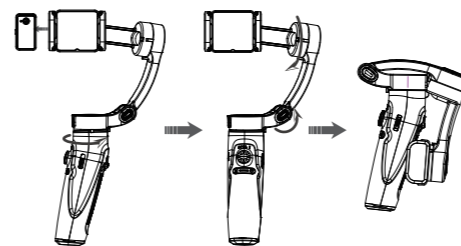

### Warning:

This device complies with Part 15 of the FCC Rules. Operation is subject to the following two conditions:

- (1) this device may not cause harmful interference, and
- (2) this device must accept any interference received, including interference that may cause undesired operation. Changes or modifications not expressly approved by the party responsible for compliance could void the user's authority to operate the equipment.

NOTE: This equipment has been tested and found to comply with the limits for a Class B digital device, pursuant to Part 15 of the FCC Rules. These limits are designed to provide reasonable protection against harmful interference in a residential installation.

This equipment generates, uses and can radiate radio frequency energy and, if not installed and used in accordance with the instructions, may cause harmful interference to radio communications. However, there is no guarantee that interference will not occur in a particular installation.

If this equipment does cause harmful interference to radio or television reception which can be determined by turning the equipment off and on, the user is encouraged to try to correct the interference by one or more of the following measures:

- Reorient or relocate the receiving antenna.
- Increase the separation between the equipment and receiver.
- Connect the equipment into an outlet on a circuit different from that to which the receiver is connected.
- Consult the dealer or an experienced radio/TV technician for help.

NOTE: This device and its antenna(s) must not be co-located operation in conjunction with any other antenna or transmitter.

The device has been evaluated to meet general RF exposure requirement. The device can be used in portable exposure condition without restriction.