



Berserker[®]

Hangzhou Berserker Trading Company Ltd.

Room 3509, Building 2, Left Right World Business Center, Ningwei Street,
Xiaoshan District, Hangzhou, Zhejiang, China

[®]
Berserker

BSK-141
CORDLESS RATCHET WRENCH
Original Instructions

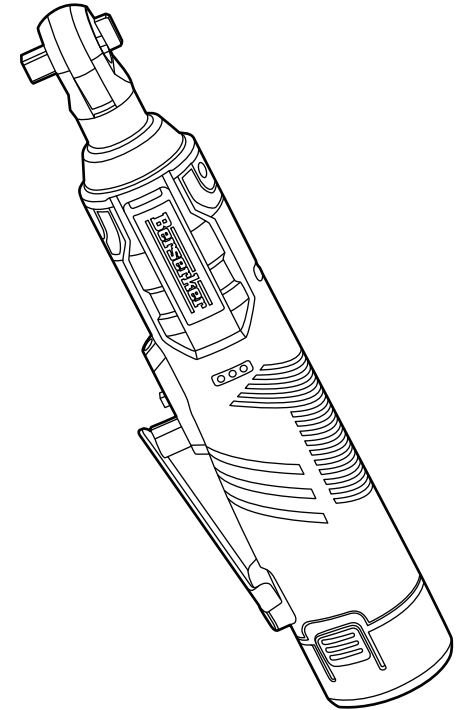

Please read the carefully before use

Attention: If you have any question during use , please contact us at Amazon after-sale service

SAFETY INSTRUCTIONS

General Safety Rules

1. Work Place

- 1) Keep the workplace clean and bright. Chaos and dark places can cause an accident.
- 2) Do not operate electric tools in explosive atmospheres, in the presence of explosive liquids, gases or dust. The spark generated by the power tool ignites dust or gas.
- 3) Operate the power tools when children and bystanders are not at the scene. Distraction will make you loose control of power tool.

2. Electrical Safety

- 1) Avoid contact with the ground surface, such as pipes, heat sinks and refrigerators. If your body is grounded, it will increase the risk of electric shock.
- 2) Do not expose the power tool to rain or moisture. Water entering the power tool will increase the risk of electric shock.

3. Personal Safety

- 1) Be alert, pay attention to the operation and stay awake when operating the power tool. Do not operate the power tool with fatigue, medication, alcohol or therapeutic response. Disenchantment during operation of the power tool can result in serious personal injury.
- 2) Use safety devices. Always wear goggles. Safety devices, such as dust masks under suitable conditions, non-slip safety shoes, helmets, hearing protection and other devices can reduce personal injury.
- 3) Remove all adjustment keys or wrenches before the power tool is switched on. A wrench or key left on a rotating part of a power tool can cause personal injury.
- 4) Do not stretch your hands too long, always pay attention to the foot and body balance. So that in the case of accidents can be a good control of power tools.
- 5) Dress properly. Do not wear loose clothing or wear jewelry. Keep your hair, clothes and sleeves away from moving parts. Loose clothing, ornaments or long hair may be involved in moving parts.

6) If provided with the chip removal device, dust collection device connected to the device, make sure they are connected and used properly. The use of these devices reduces the risk of debris.

4. Power Tools Use and Precautions

- 1) Do not abuse the power tool, use the appropriate power tool according to the application. Choosing the right design power tool will make your work more efficient and safer.
- 2) If the switch can not be switched on or off, the power tool can not be used. Power tools that can not be controlled by switches are dangerous and must be repaired.
- 3) Store the idle power tools out of the range of children and do not operate the power tools with those who are not familiar with the power tools or who do not understand them. Power tools are dangerous in the hands of untrained users.
- 4) Maintenance of power tools. Check the mounting deviation or stuck of the moving parts, damage to the parts and other conditions that affect the operation of the electric tool, if damaged, the power tool must be repaired before use. Many accidents are caused by poorly maintained power tools.
- 5) Keep the cutting tool sharp and clean. A well maintained tool with a sharp cutting edge is not easy to jam and easy to control.
- 6) Use power tools, accessories, and tool heads, etc depending on the operating instructions and the specific type of power required to use the power tool, taking into account the operating conditions and the operations performed. Using power tools as those that do not comply with the requirements may result in a dangerous situation.

5. Repair

- 1) Send your power tool to a professional service technician and use the same spare parts for replacement. This will ensure the safety of the repaired power tool.
- 2) If not used for a long time, charging the battery pack once a month will prolong the service life of the machine.

Product Instruction

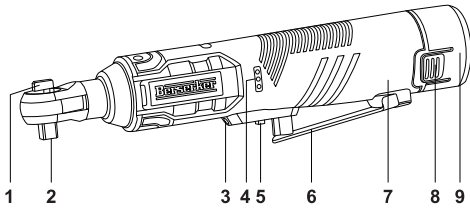

- 1. Knob of ratchet head
- 2. Output shaft
- 3. LED light
- 4. Battery indicator
- 5. Lock-off switch
- 6. Paddle switch
- 7. Motor housing
- 8. Battery release button
- 9. Battery

Technical Data

Cordless Ratchet Wrench	
Article number	BSK-141
Rated voltage	12 V
No load speed	0-260 rpm
Output shaft	3/8 inch
Max torque	35 Ft-lbs

PRODUCT DESCRIPTION

Operation Instruction

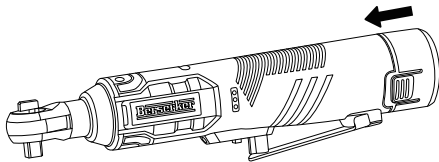

1. Installing the battery according to the direction.

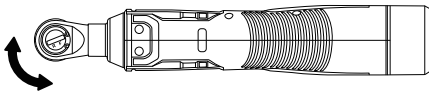

2. Adjust the knob of ratchet head. Turning R is forward, locking bolt; Turning F is reversing, exiting bolt.

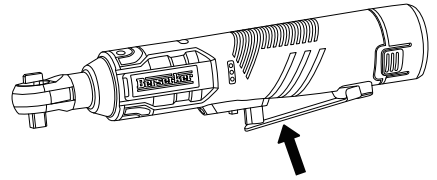

3. When pressing the paddle switch, the ratchet wrench start to work.

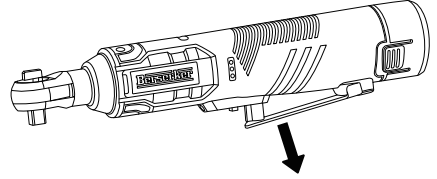

4. When loosening the paddle switch, the machine stop working.

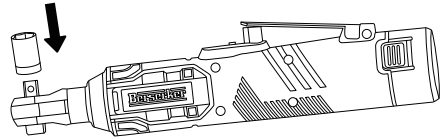

5. Installing the sleeve: Insert the sleeve according to the direction.

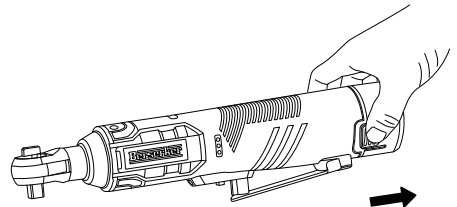

6. Press the battery release button to remove the battery according the direction.

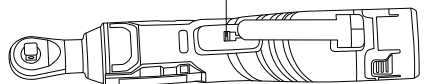
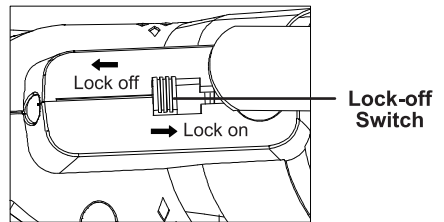

7. Battery tools are always in operating condition. Therefore, always set the lock-off switch in "LOCK" position and remove the battery pack when the tool is not in use or when carrying the wrench at your side.

Important Safety Precautions for Battery Packs

1. Before using the battery pack, please carefully read the relevant instructions and (1) the charger (2) the battery pack and (3) the warning mark on the product that requires the use of the battery.

2. Do not disassemble the battery pack.

3. If the working time is significantly shorter, you should immediately stop the operation. Otherwise it will cause overheating, or even explode.

4. If the electrolyte splashes into eyes, immediately rinse with water and seek medical treatment. otherwise it may lead to blindness.

5. Do not make the battery pack for a long time short circuit.

- 1) Do not allow any conductor to come into contact with the battery terminals.
- 2) Do not put the battery pack with nails, coins and other metal objects stored in the same container.
- 3) Do not put the battery pack in water or rain. Battery short circuit can lead to current increases, overheating, burning or even breakdown.

6. Tools and battery packs shall not be stored where the temperature is likely to reach or exceed 50°C (122°F).

7. Even if the battery pack has been severely damaged or completely depleted, and can not be burned. The battery pack will explode in the fire.

8. Pay attention to the battery pack, do not drop, shake, bump or use as a hammer and so on.

Keep The Maximum Battery Life Expectation

1. Charge the battery pack before it is fully discharged. When the machine is found to be insufficient, be sure to stop the machine and charge the battery pack.

2. Do not overcharge the battery pack. Excessive charging will shorten battery life.

3. The battery pack should be stored under the indoor temperature of 10°C-40°C (50°F-104°F).

Charging Instructions

1. Charging, indicating that the red light is always on. (When the battery pack is used up, plug the charger, the green light turns on, indicating overheating protection, then wait for the battery pack to cool before charging).

2. Full of electricity, indicating that the green light is always bright.

3. In the charging process, (such as the indicator light does not shine, flashing lights and other abnormalities, please do not intermittent charge, immediately sent to professional personnel for maintenance).

Charge Battery

To Charge the battery, align the battery pack with the bay and slide the battery pack into the charger as far as possible. The red light will come on, either flashing (battery pack is too hot or cold) or continuous (pack is charging). A fully discharged battery pack with an internal temperature in the normal range will charge in 40 to 90 minutes, depending on the battery pack and charger.

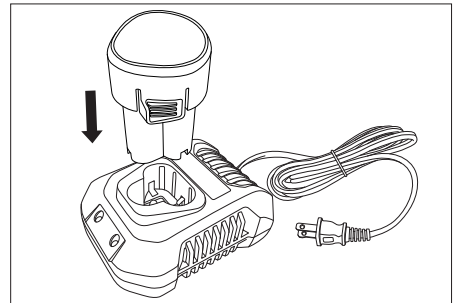

Charger Indicator

Light	Status
Red on ● []	Charging
Green on ● []	Fully Charged
Green flash ● [x]	Charging fault
Red green on ● [x]	Charging fault

MAINTENANCE AND TRANSPORTATION

Maintenance and Cleaning

- ▶ **Remove the battery from the power tool before carrying out work on the power tool (e.g. maintenance, changing tool, etc.). The battery should also be removed for transport and storage.** There is risk of injury from unintentionally pressing the on/off switch.

Transport

The contained lithium-ion batteries are subject to the Dangerous Goods Legislation requirements.

The batteries are suitable for road-transport by the user without further restrictions.

When shipping by third parties (e.g.: by air transport or forwarding agency), special requirements on packaging and labelling must be observed. For preparation of the item being shipped, consulting an expert for hazardous material is required.

Dispatch battery packs only when the housing is undamaged. Tape or mask off open contacts and pack up the battery in such a manner that it cannot move around in the packaging. Please also observe the possibility of more detailed national regulations.

Disposal



Power tools, rechargeable batteries, accessories and packaging should be sorted for environmental-friendly recycling.



Do not dispose of power tools and batteries/ rechargeable batteries into household waste!