

# XB5AVM3

Harmony XB5, Pilot light, plastic, green, Ø22, plain lens with integral LED, 230...240 V AC



## Main

|                                 |                         |
|---------------------------------|-------------------------|
| Range of product                | Harmony XB5             |
| Product or component type       | Pilot light             |
| Device short name               | XB5                     |
| Bezel material                  | Dark grey plastic       |
| Fixing collar material          | Plastic                 |
| Head type                       | Standard                |
| Mounting diameter               | 0.87 in (22 mm)         |
| Sale per indivisible quantity   | 1                       |
| Shape of signaling unit head    | Round                   |
| Cap/operator or lens colour     | Green                   |
| Operator additional information | With plain lens         |
| Light source                    | Protected LED           |
| Bulb base                       | Integral LED            |
| Light source colour             | Green                   |
| [Us] rated supply voltage       | 230...240 V AC 50/60 Hz |
| Device presentation             | Complete product        |

## Complementary

|  |   |
|--|---|
| Height                                 | 1.65 in (42 mm)   |
| Width                                  | 1.18 in (30 mm)   |
| Depth                                  | 2.13 in (54 mm)   |
| Terminals description ISO n°1          | (X1-X2)PL   |
| Net Weight                             | 0.08 lb(US) (0.038 kg)  |
| Resistance to high pressure washer     | 1015.26 psi (7000000 Pa) 131 °F (55 °C) 0.1 m   |
| Connections - terminals                | Screw clamp terminals, <= 2 x 1.5 mm <sup>2</sup> with cable end conforming to EN/IEC 60947-1<br>Screw clamp terminals, 1 x 0.22...2 x 2.5 mm <sup>2</sup> without cable end EN/IEC 60947-1 |
| [Ui] rated insulation voltage          | 250 V 3)EN 60947-1  |
| [Uimp] rated impulse withstand voltage | 4 kV EN 60947-1   |
| Signalling type                        | Steady  |
| GCR BRIDGE                             | XB5AVCUST05   |
| Compatibility code                     | XB5   |
| Supply voltage limits                  | 195...264 V AC  |
| Current consumption                    | 14 mA   |
| Service life                           | 100000 h at rated voltage and 25 °C   |
| Surge withstand                        | 1 kV IEC 61000-4-5  |

The information provided in this documentation contains general descriptions and/or technical characteristics of the performance of the products contained herein. This documentation is not intended as a substitute for and is not to be used for determining suitability or reliability of these products for specific user applications. It is the duty of any such user or integrator to perform the appropriate and complete risk analysis, evaluation and testing of the products with respect to the relevant specific application or use thereof. Neither Schneider Electric Industries SAS nor any of its affiliates or subsidiaries shall be responsible or liable for misuse of the information contained herein.

## Environment

|                                       |   |
|---------------------------------------|---|
| Protective treatment                  | TH  |
| Ambient air temperature for storage   | -40...158 °F (-40...70 °C)  |
| Ambient air temperature for operation | -40...158 °F (-40...70 °C)  |
| Overvoltage category                  | Class II IEC 60536  |
| IP degree of protection               | IP66 IEC 60529<br>IP67 IEC 60529<br>IP69 IEC 60529<br>IP69K ISO 20653   |
| NEMA degree of protection             | NEMA 13<br>NEMA 4X  |
| IK degree of protection               | IK05 conforming to IEC 50102  |
| Product certifications                | UL Listed<br>CSA  |
| Vibration resistance                  | 5 gn 12...500 Hz)IEC 60068-2-6  |
| Shock resistance                      | 50 gn 18 ms) half sine wave acceleration IEC 60068-2-27<br>30 gn 11 ms) half sine wave acceleration IEC 60068-2-27  |
| Resistance to fast transients         | 2 kV IEC 61000-4-4  |
| Resistance to electromagnetic fields  | 9.14 V/m (10 V/m) IEC 61000-4-3   |
| Electromagnetic compatibility         | Electrostatic discharge 6 kV on contact (on metal parts)) IEC 61000-4-2<br>Electrostatic discharge 8 kV in free air (in insulating parts)) IEC 61000-4-2<br>Electromagnetic emissionclass B IEC 55011 |
| Resistance to electrostatic discharge | 6 KV on contact (on metal parts) IEC 61000-4-2<br>8 kV in free air (in insulating parts) IEC 61000-4-2  |
| Electromagnetic emission              | Class B IEC 55011   |

## Ordering and shipping details

|                       |                                       |
|-----------------------|---------------------------------------|
| Category              | 22467 - PUSHBUTTONS,22MM(PLASTIC) NEW |
| Discount Schedule     | CS2                                   |
| GTIN                  | 00785901942290                        |
| Nbr. of units in pkg. | 1                                     |
| Package weight(Lbs)   | 0.06 lb(US) (0.03 kg)                 |
| Returnability         | No                                    |
| Country of origin     | FR                                    |

## Packing Units

|                              |                          |
|------------------------------|--------------------------|
| Unit Type of Package 1       | PCE                      |
| Package 1 Height             | 1.34 in (3.4 cm)         |
| Package 1 width              | 2.13 in (5.4 cm)         |
| Package 1 Length             | 3.46 in (8.8 cm)         |
| Unit Type of Package 2       | S03                      |
| Number of Units in Package 2 | 150                      |
| Package 2 Weight             | 12.98 lb(US) (5.887 kg)  |
| Package 2 Height             | 11.81 in (30 cm)         |
| Package 2 width              | 11.81 in (30 cm)         |
| Package 2 Length             | 15.75 in (40 cm)         |
| Unit Type of Package 3       | P06                      |
| Number of Units in Package 3 | 1200                     |
| Package 3 Weight             | 124.03 lb(US) (56.26 kg) |
| Package 3 Height             | 31.50 in (80 cm)         |
| Package 3 width              | 31.50 in (80 cm)         |
| Package 3 Length             | 23.62 in (60 cm)         |

## Offer Sustainability

|                            |   |
|----------------------------|---|
| Sustainable offer status   | Green Premium product   |
| California proposition 65  | WARNING: This product can expose you to chemicals including: Lead and lead compounds, which is known to the State of California to cause cancer and birth defects or other reproductive harm. For more information go to <a href="http://www.P65Warnings.ca.gov">www.P65Warnings.ca.gov</a> |
| REACH free of SVHC         | Yes   |
| EU RoHS Directive          | Pro-active compliance (Product out of EU RoHS legal scope) <a href="#">EU RoHS Declaration</a>  |
| Mercury free               | Yes   |
| RoHS exemption information | <a href="#">Yes</a>   |
| China RoHS Regulation      | <a href="#">China RoHS Declaration</a>  |
| Environmental Disclosure   | <a href="#">Product Environmental Profile</a>   |
| Circularity Profile        | <a href="#">End Of Life Information</a>   |
| WEEE                       | The product must be disposed on European Union markets following specific waste collection and never end up in rubbish bins.  |

## Contractual warranty

|          |           |
|----------|-----------|
| Warranty | 18 months |
|----------|-----------|

## Dimensions

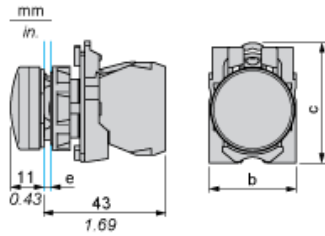

- e: clamping thickness: 1 to 6 mm / 0.04 to 0.24 in.
- b: 30 mm / 1.18 in.
- c: 41.5 mm / 1.63 in.

Panel Cut-out for Pushbuttons, Switches and Pilot Lights (Finished Holes, Ready for Installation)

Connection by Screw Clamp Terminals or Plug-in Connectors or on Printed Circuit Board

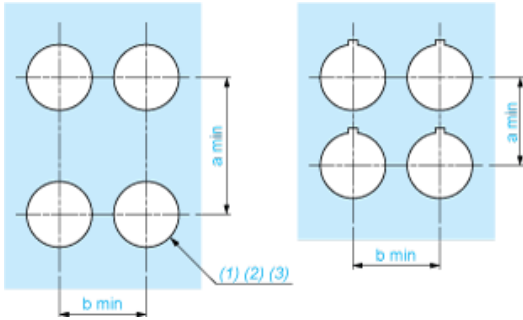

- (1) Diameter on finished panel or support
- (2) For selector switches and Emergency stop buttons, use of an anti-rotation plate type ZB5AZ902 is recommended.
- (3)  $\varnothing 22.5$  mm recommended ( $\varnothing 22.3 \text{ }_0^{+0.4}$ ) /  $\varnothing 0.89$  in. recommended ( $\varnothing 0.88 \text{ in. }_0^{+0.016}$ )

| Connections                                   | a in mm | a in in. | b in mm | b in in. |
|---|---------|----------|---------|----------|
| By screw clamp terminals or plug-in connector | 40      | 1.57     | 30      | 1.18     |
| By Faston connectors                          | 45      | 1.77     | 32      | 1.26     |
| On printed circuit board                      | 30      | 1.18     | 30      | 1.18     |

Detail of Lug Recess

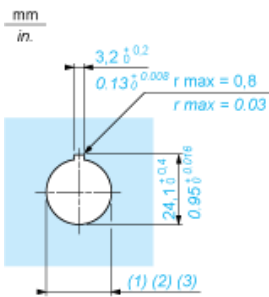

- (1) Diameter on finished panel or support
- (2) For selector switches and Emergency stop buttons, use of an anti-rotation plate type ZB5AZ902 is recommended.
- (3)  $\varnothing 22.5$  mm recommended ( $\varnothing 22.3 \text{ }_0^{+0.4}$ ) /  $\varnothing 0.89$  in. recommended ( $\varnothing 0.88 \text{ in. }_0^{+0.016}$ )