

NOR-LAKE® SCIENTIFIC

PREMIER™ GLASS DOOR

LOW TEMPERATURE FREEZER -25°C

Designed to meet the demanding requirements for scientific and laboratory research. Advanced engineered design incorporates the latest in cabinet, refrigeration, temperature control and monitoring features. Provides energy efficient, convenient, safe and reliable performance for optimal storage temperature environments necessary for a wide range of life science, pharmacy, biological, medical, clinical and industrial applications.

Standard features include:

- Digital LED Microprocessor temperature controller with Hi/Lo audible and visual alarm
- Remote alarm contacts
- Adjustable temperature control range from -15°C to -25°C. Factory preset at -20°C
- Continuous product temperature display
- Product sensor with glycerin bottle
- Power supply switch
- Exterior cabinet front, sides and back are painted white
- Exterior cabinet top and bottom are galvanized steel
- Interior cabinet liner painted white
- Cabinet is foamed-in-place with CFC Free high density polyurethane foam insulation
- Glass door(s), full size, double pane, with anti-condensate heater wires
- Heavy duty door pivot hinges
- Centered key door locks (2 keys)
- Pull door handles(s)
- Four casters (2 locking)
- 3 epoxy coated wire shelves per door
- Perimeter anti-condensate door opening heater wires
- Magnetic door gasket
- Interior LED light
- Air cooled condensing unit
- Top mounted forced air refrigeration system
- Automatic defrost and condensate evaporation
- Warranties: 18 month parts and labor, 5 year compressor (US and Canada) 18 months parts (International)
- UL/C-UL listed

Optional features include:

- Legs in lieu of casters
- Stainless steel drawer (8 per door)
- Wire basket drawer (8 per door)
- Extra shelf
- Stainless steel exterior
- Stainless steel interior
- 4-20ma output
- Temperature chart recorder with chart paper
- Sensor access port 1" diameter
- Export crating



NSXF211WWG/0



NSXF211WWG/0

NSXF482WWG/0

NORLAKE SCIENTIFIC

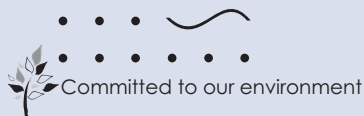

Nor-Lake, Inc.
Registered to ISO 9001:2008
File No. 10001816

NOR-LAKE SCIENTIFIC
A Division of
NOR-LAKE, INCORPORATED
727 Second Street
P.O. Box 248
Hudson, Wisconsin 54016
800-477-5253
715-386-2323
800-388-5253 PARTS
715-386-4290 FAX
www.norlakescientific.com

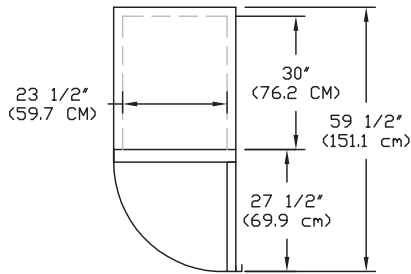

NSXF211WWG/0

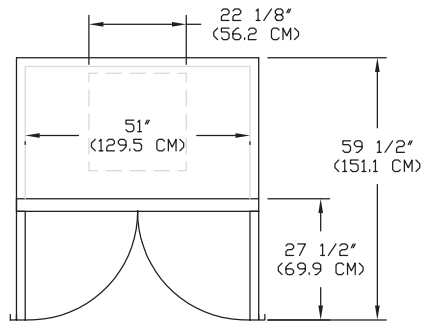

NSXF482WWG/0

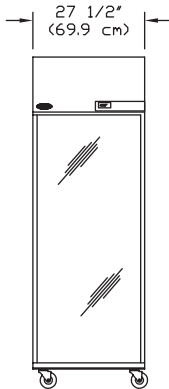

**NSXF211WWG/0
FRONT**

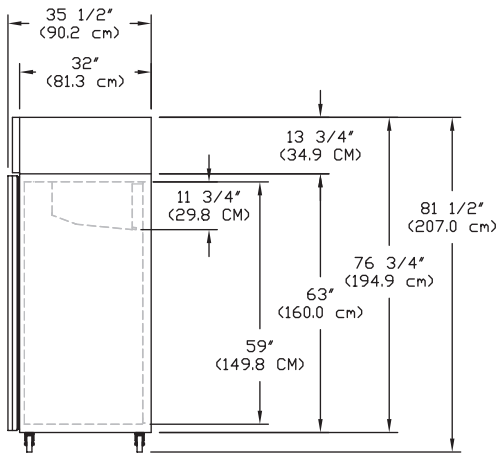

**NSXF211WWG/0
SIDE**

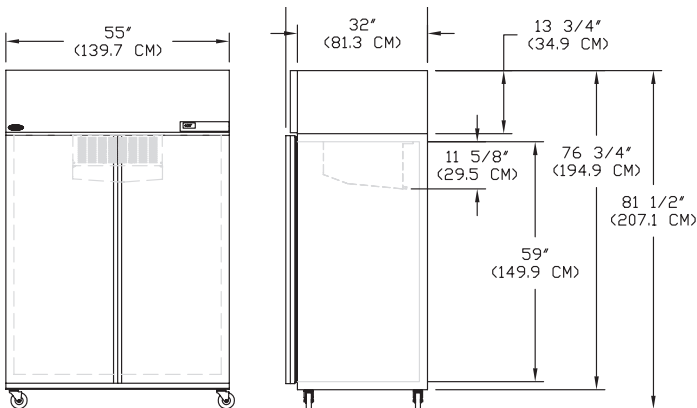

**NSXF482WWG/0
FRONT SIDE**

SPECIFICATIONS

Model	NSXF211WWG/0	NSXF482WWG/0
Crated Height (in) (cm)	81" (205)	83" (210)
Crated Width (in) (cm)	37" (94)	59" (149)
Crated Depth (in) (cm)	38" (96)	38" (96)
Crated Weight (lbs) (kg)	485 (181)	700 (317)
Interior Height (in) (cm)	59" (149)	59" (149)
Interior Width (in) (cm)	23-1/2" (59)	51" (129)
Interior Depth (in) (cm)	30" (76)	30" (76)
Overall Height (in) (cm)	81-1/2" (207)	81-1/2" (207)
Overall Width (in) (cm)	27-1/2" (69)	55" (139)
Overall Depth (in) (cm)	35-1/2" (90)	35-1/2" (90)
Gross Cubage (ft. ³) (l)	22.5 (639)	48.8 (1381)
Shelf Area (ft ²)	18.3 (1.7)	39.7 (3.7) includes floor
Number of Shelves	3	6
Number of Casters	4	4
Condensing Unit Size	1 HP	1 HP
Refrigerant	R-404A	R-404A
Electrical Characteristics	115/60/1	115/60/1
Cord & Plug Supplied	Yes	Yes
Maximum Fuse Size	20 Amp	20 Amp
Total Amp Draw	15.8	15.8

Specifications subject to change without notice.

Voltage Model Suffix Code	Voltage Description	NEMA Plug	NEMA Receptacle
/0	115/1PH/60HZ	5-20P	5-20R



NORLAKE SCIENTIFIC

Revision Date: 02/13
©2013 NOR-LAKE, INC.
Printed in the U.S.A.
Part Number: 121228

