

# NOR-LAKE<sup>®</sup> SCIENTIFIC UNDERCOUNTER FREEZERS

-20°C Manual Defrost For General Laboratory / Pharmacy Storage

Designed to meet the demanding requirements for scientific and laboratory research. Advanced engineered design incorporates the latest in cabinet, refrigeration, temperature control and monitoring features. Provides energy efficient, convenient, safe and reliable performance for optimal storage temperature environments necessary for a wide range of life science, pharmacy, biological, medical, clinical, and industrial applications.

## Standard Features:

- Adjustable control range from -10°C to -20°C factory preset at -20°C
- Exterior cabinet front, sides and back are painted white
- Exterior cabinet back and bottom are galvanized steel
- Interior cabinet liner and interior door smooth aluminum
- Cabinet and solid door are foamed-in-place with CFC Free high density polyurethane foam insulation
- Heavy duty solid door with hinges
- Pull door handle
- Magnetic door gasket
- Centered key door lock (2 keys)
- Four 4" legs
- 1 coated wire shelf
- Cold wall evaporator refrigeration system
- Base mounted forced air refrigeration system
- Manual defrost
- Air intake and exhaust through the base of the unit for build-in on three sides
- Warranties: 18 month parts and labor, 5 year compressor (US and Canada), 18 months parts (International)
- UL/CUL listed

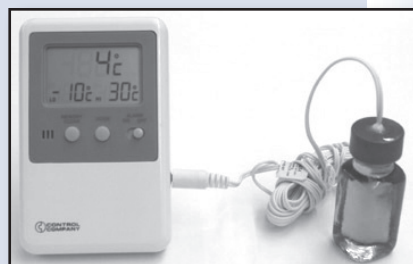

**Digital Thermometer Alarm  
(optional)**

## Optional Features:

- Extra shelf
- Sensor access port 1" diameter
- Casters in lieu of legs
- Levelers in lieu of legs
- Stainless steel interior
- Stainless steel exterior
- Digital thermometer monitor with alarm (Field Install)
- Temperature chart recorder with chart paper
- Export crating



**NSLF051WMW/0M**



**NSLF051WMW/0M  
shown with optional casters**

**NORLAKE SCIENTIFIC**



Committed to our environment



Nor-Lake, Inc.  
Registered to ISO 9001:2008  
File No. 10001816

NOR-LAKE SCIENTIFIC  
A Division of  
NOR-LAKE, INCORPORATED  
727 Second Street  
P.O. Box 248  
Hudson, Wisconsin 54016  
800-477-5253  
715-386-2323  
800-388-5253 PARTS  
715-386-4290 FAX  
[www.norlakescientific.com](http://www.norlakescientific.com)

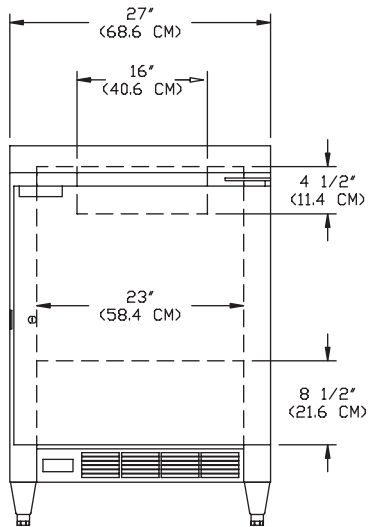

**Front View - NSF051WMW/0M**

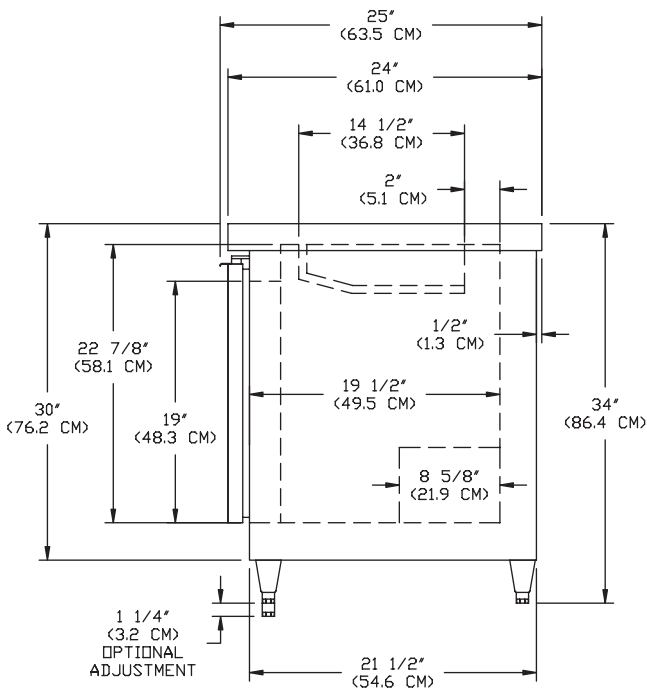

**Side View - NSF051WMW/0M**

**SPECIFICATIONS**

Models	NSLF051WMW/0M
Crated Height (in) (cm)	34-1/4" (87)
Crated Width (in) (cm)	31-1/4" (79)
Crated Depth (in) (cm)	28" (71)
Crated Weight (lbs) (kg)	180 (81)
Interior Height (in) (cm)	22-7/8" (58)
Interior Width (in) (cm)	23" (58)
Interior Depth (in) (cm)	19-1/2" (49)
Overall Height - Adjustable* (in) (cm)	34" (86) to 35-1/4" (89)
Overall Width (in) (cm)	27" (68)
Overall Depth (in) (cm)	25" (63)
Gross Cubage (ft.3) (m3)	5.9 (0.1)
Shelf Area (sq. ft) (m2)	2.6 (0.2)
Number of Shelves	1
Number of Legs	4
Condensing Unit Size	1/2 HP
Refrigerant	R-404A
Electrical Characteristics	115/60/1
Cord & Plug Furnished	Yes
Maximum Fuse Size	15 AMPS
NEMA Plug	5-15P
Total Amp Draw	6.0

Specifications subject to change without notice.

\* The overall heights shown in the table and drawings are with 4" adjustable legs. With the 3-5/8" casters the overall height is 33-5/8". With 2" levelers the overall height is adjustable from 32" to 32-1/2".

**Manual Defrost Freezer**

This is a cold wall freezer model which employs evaporator tubing embedded in the sidewalls, back, and top of the unit. During the refrigeration process, heat is removed through the evaporator tubing and expelled through the condensing unit. It will be necessary to occasionally manually defrost the freezer when frost has accumulated. To do this, unplug the unit and open the door. Wipe the cabinet dry when defrosting is complete.

Voltage Model Suffix Code	Voltage Description	NEMA Plug	NEMA Receptacle
/0	115V, 1PH, 60HZ	5-15P	5-15R

**NORLAKE SCIENTIFIC**

Revision Date: 7/10  
 ©2010 NOR-LAKE, INC.  
 Printed in the U.S.A.  
 Part Number: 143346

