

**OGE081**

OGE-HBOW/LS/CUBE

Photoelectric sensors

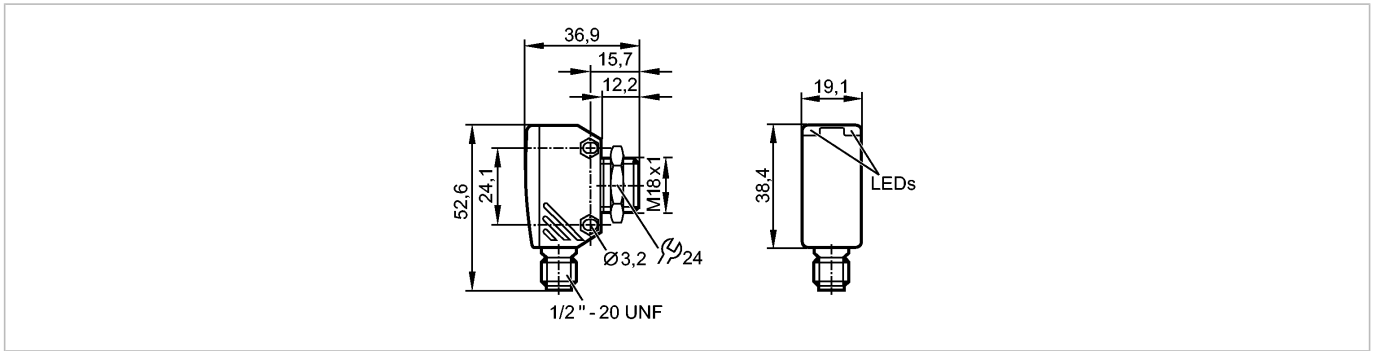

Made in USA

**Product characteristics**

Through-beam sensor
Cube
Connector
Receiver
Sensing range 20m

**Electrical data**

Electrical design	AC
Operating voltage [V]	20...250 AC (47...63 Hz)
Type of light	Red light 633 nm
Protection class	II *)

**Outputs**

Output function	light-on mode
Voltage drop [V]	< 8
Minimum load current [mA]	5
Leakage current [mA]	< 1.7

**Current rating**

- Current rating (continuous) [mA]	200 (...40 °C) / 150 (...60 °C)
- Current rating (peak) [mA]	î: 1200 (20 ms / 0.5 Hz)
Short-circuit protection	no
Overload protection	no
Switching frequency [Hz]	30

**Range**

Sensing range [m]	20
-------------------	----

**Excess gain graphs**

x: distance in [m]  
y: excess gain factor

## OGE081

OGE-HBOW/LS/CUBE

Photoelectric sensors

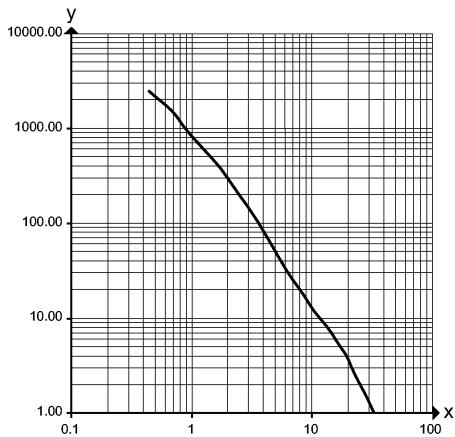

### Environment

Ambient temperature	[°C]	-25...60
Protection		IP 67

### Tests / approvals

EMC		EN 60947-5-2 EN 55011 (Emission):	class B
MTTF	[Years]		365

### Mechanical data

Housing materials		Zinc Alloy; PEI
Lens material		PMMA
Weight	[kg]	0.06

### Displays / operating elements

Output status indication	LED	yellow
--------------------------	-----	--------

### Electrical connection

Connection		1/2" connector
------------	--	----------------

### Wiring

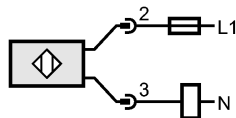

Note: miniature fuse to IEC60127-2 sheet 1,  
≤ 2 A (fast acting)

### Accessories

Accessories (included)		1 lock nut
------------------------	--	------------

### Remarks

Remarks		Do not connect without a load *) double insulated
---------	--	--

Pack quantity	[piece]	1
---------------	---------	---