

OGH080

OGH-XBOW/LS/CUBE/100MM

Photoelectric sensors

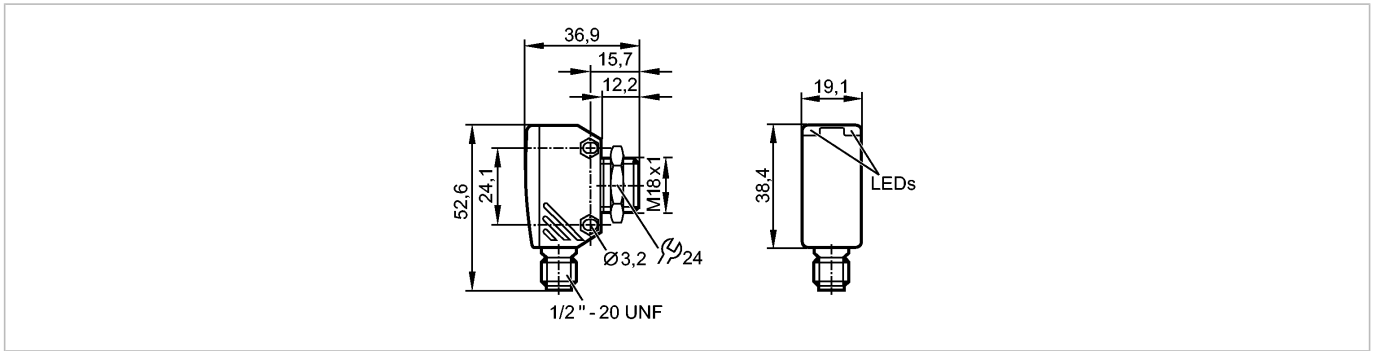

Made in USA

Product characteristics

Diffuse reflection sensor
Cube
Connector
Background suppression
Range 100mm (Range referred to white paper 200 x 200 mm, 90 % remission)

Electrical data

Electrical design	AC
Operating voltage [V]	20...250 AC (47...63 Hz)
Type of light	Red light 633 nm
Protection class	II *)

Outputs

Output function	light-on mode
Voltage drop [V]	< 8
Minimum load current [mA]	5
Leakage current [mA]	< 1.7

Current rating

- Current rating (continuous) [mA]	200 (...40 °C) / 150 (...60 °C)
- Current rating (peak) [mA]	î: 1200 (20 ms / 0.5 Hz)
Short-circuit protection	no
Overload protection	no
Switching frequency [Hz]	20

Range

Range [mm]	100 (Range referred to white paper 200 x 200 mm, 90 % remission)
Light spot diameter [mm]	11 (at maximum range)

Environment

Ambient temperature [°C]	-25...60
Protection	IP 67

Tests / approvals

EMC	EN 60947-5-2 EN 55011 (Emission): class B
MTTF [Years]	334

Mechanical data

Housing materials	Zinc Alloy; PEI
Lens material	PMMA

OGH080

OGH-XBOW/LS/CUBE/100MM

Photoelectric sensors

Weight	[kg]	0.06
--------	------	------

Displays / operating elements

Output status indication	LED	yellow
--------------------------	-----	--------

Electrical connection

Connection	1/2" connector
------------	----------------

Wiring

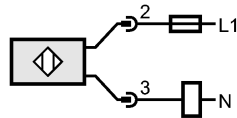

Note: miniature fuse to IEC60127-2 sheet 1,
 ≤ 2 A (fast acting)

Accessories

Accessories (included)	1 lock nut
------------------------	------------

Remarks

Remarks	Do not connect without a load *) double insulated
---------	--

Pack quantity	[piece]	1
---------------	---------	---